

PROPOSED MASTERPLAN

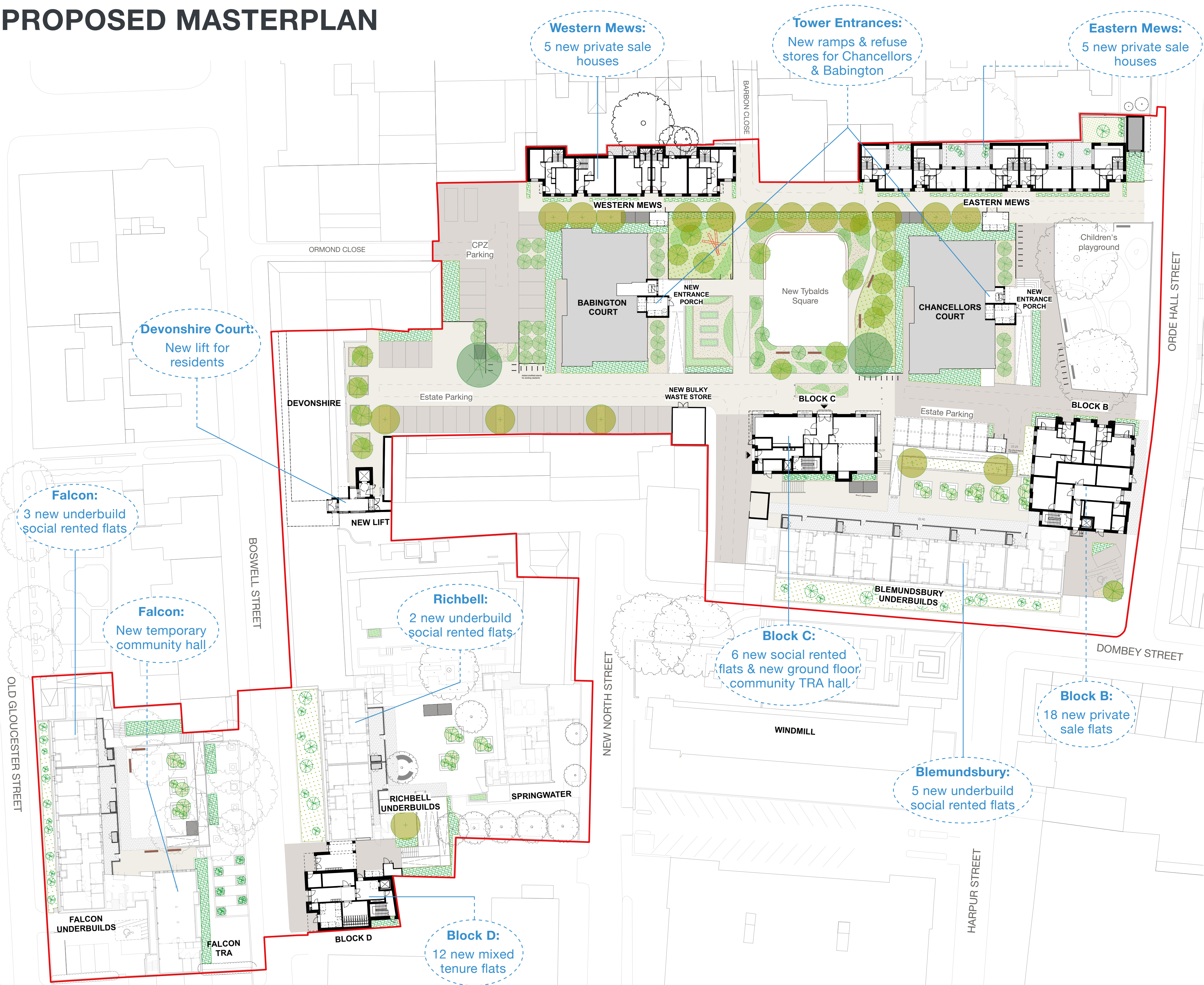

OVERVIEW:

Our proposals are for a comprehensive redevelopment of Tybalds Estate to provide **56 new homes** and an enhanced and improved public realm. The proposals include:

BLOCK B: 18 Private Tenure units

BLOCK C: TRA Hall and 6 Social Tenure units

BLOCK D: 12 Mixed Tenure units

EASTERN MEWS: 5 Private Tenure units

WESTERN MEWS: 5 Private Tenure units

UNDERBUILDS BLEMUNDSBURY: 5 Social Tenure units & PVs on roof

UNDERBUILDS FALCON: TRA Hall, 3 Social Tenure units and PVs on roof

UNDERBUILDS RICHBELL: 2 Social Tenure units and PVs on roof

UNDERBUILDS SPRINGWATER: New caretaker's office

DEVONSHIRE COURT: New Lift

NEW BULKY WASTE STORE

BABINGTON & CHANCELLORS COURT: New entrance porches

LOCAL LETTINGS PLAN

A Tybalds local lettings plan will initially ring-fence the new social and affordable housing homes including those homes provided by a housing association, for existing Tybalds council tenants in housing need.

All homes on the estate vacated by tenants moving to the new flats would also be initially ring-fenced for re-letting to estate residents.

Camden's housing allocations system will assess housing need.

