

**Date:** 05/11/2019  
**Our reference:** PS\_07/Laystall\_St/ML  
**Email:** [maxim.lyne@camden.gov.uk](mailto:maxim.lyne@camden.gov.uk)

**Transport Strategy**  
Supporting Communities  
London Borough of Camden  
Town Hall  
Judd Street  
London  
WC1H 9JE  
Phone: 020 7974 1665  
[camden.gov.uk](http://camden.gov.uk)

1st Floor West Block  
Panther House  
38 Mount Pleasant  
London  
WC1X 0AN

Dear resident/stakeholder

## Laystall Street

### Pedestrian and cycle access improvements

We are writing to inform you of the Council's proposal to improve pedestrian and cycling access in Laystall Street. This is in line with the council's goals of encouraging non-polluting forms of transport and healthier ways of getting about, particularly walking and cycling.

#### Proposed changes

We are proposing to introduce measures that will restrict access to motor traffic on Laystall Street between Mount Pleasant and Rosebery Avenue. This would be carried out under an Experimental Traffic Order (ETO) in order to determine the level of impact on Mount Pleasant. It is proposed that the ETO will be in place for 6 months, with a separate consultation after this time should the decision be taken to make the measure permanent.

This measure will prevent the route from being used as a motor traffic cut through between Mount Pleasant and Rosebery Avenue, creating a more pleasant pedestrian environment and permitting safer access to the Christopher Hatton school. It will also allow two way cycle movement, which will complement the recently installed point closure at the southern end of Gough Street, to create a quiet North – South cycle route parallel to Gray's Inn Road.

Motor vehicles prohibited signs will be used at either end of the measure. Motor vehicle access to the school and to Mullen Tower will be maintained, with two way motor traffic permitted between the entrance to Mullen Tower and Mount Pleasant. A removable bollard located at the mid point on Laystall Street will provide a physical restriction to general traffic whilst maintaining refuse collection and emergency service access.

A loading point will be created on Mount Pleasant in place of an existing resident parking bay to replace the existing loading bay on Laystall Street, which will now be used as a passing place to allow the aforementioned two way traffic movement. The total loss of parking required to implement the scheme will therefore be one resident bay.

In addition to this, a 7.5t weight restriction will be implemented at the junction of Mount Pleasant and Elm Street in order to restrict access on Mount Pleasant to larger Heavy Goods Vehicles. No through road signage will be used at the junction of Mount Pleasant and Elm Street warning motorists that Laystall Street is no longer a through route.

The proposed measure is shown in the drawing below.

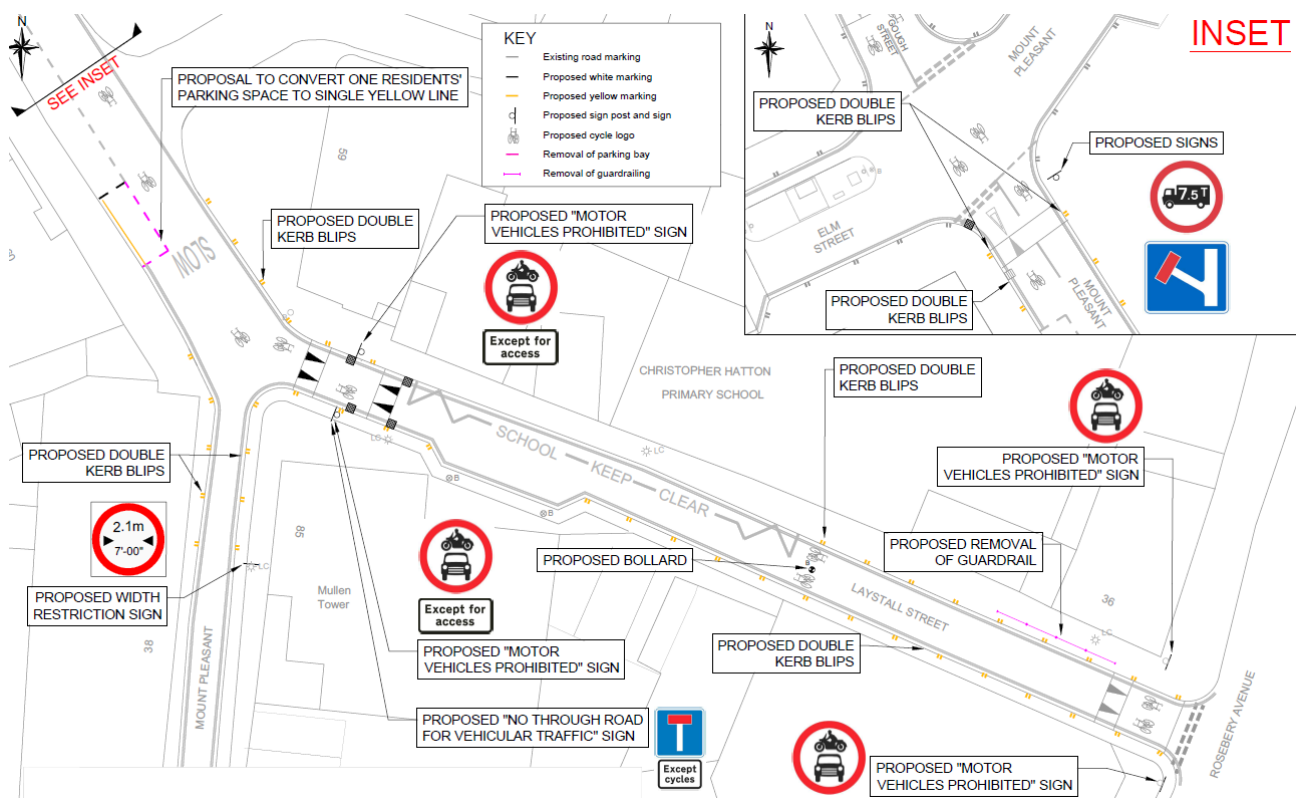

The Council welcomes your views on the proposals as well as any alternative suggestions or objections that you may have.

## HOW TO RESPOND

Please submit your response to this consultation no later than Friday 6<sup>th</sup> December 2019 via one of the following two options below:

**Option 1 Email** – submit your response via email to: [maxim.lyne@camden.gov.uk](mailto:maxim.lyne@camden.gov.uk)

**Option 2 Post** – submit your response using the following **free post address** (no stamp required) to Transport Strategy Service, FAO Max Lyne, 5<sup>th</sup> Floor, 5PS, **FREEPOST RSLT-RJBR-TXAA**, London Borough of Camden, Town Hall, Judd Street, London, WC1H 9JE.

**Please Note:** if you are responding on behalf of an organisation, only **ONE** reply will be accepted. You **must** give your full postal address when responding to the consultation if you want us to consider your views.

## **Who is being consulted?**

All properties on Laystall Street between Elm Street and Rosebery Avenue, and all properties on Mount Pleasant are being consulted along with local and statutory groups, emergency services and ward councillors.

An Equality & Diversity form has been included that can be completed voluntarily and sent to us with your response via email or using free post address as outlined above. Any information you provide on this form will help us in making an informed decision on the scheme.

While it may not be possible to reply to individual comments, all comments will be taken into account. At the end of the consultation period, officers will consider all responses received, these will be outlined in a decision report along with recommendations. This report will be presented to the Director of Regeneration and Planning (Supporting Communities Directorate) who will make a decision whether or not to proceed with implementing the proposals.

Under the Local Government Access to Information Act 1985, your consultation response will be available for inspection if required; however, your personal details will remain confidential. Please only write to us with matters associated with this consultation. If you do have any further questions or require clarification about the proposed scheme, please do not hesitate contact me on the above contact details.

Yours faithfully,

Max Lyne  
**Principal Transport Planner, Public Realm and Planning team**  
**Transport Strategy Service**