

A	SM	14/11/24	Preliminary
Rev	By	Date	Amendments

Camden
 Design Team
 Transport Strategy Service
 London Borough of Camden
 5 Pancras Square
 Tel 020 7974 5551, Fax 020 7974 6952
 DX 2106 Euston, Minicom 020 7974 6866

Project: C51

Drawing Title: Consultation Plan Overall Sheet

Scale: NTS @ A3	Date: Nov 2024
Drawn By: SM	File Ref: -
Checked By: -	Dwg Name: -

Drawing Location: -	Rev: A
Drawing Number: -	



Key plan - Sheet 1

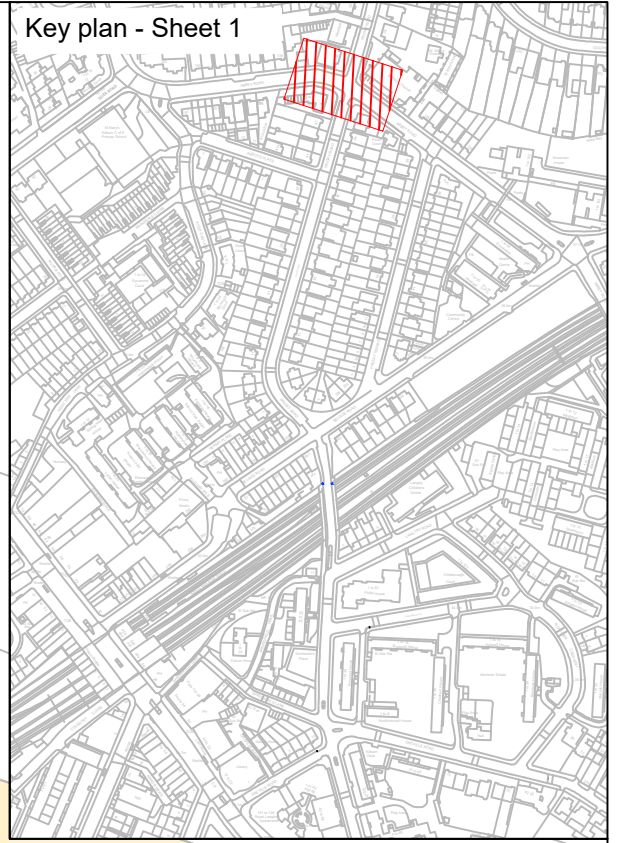

Removal of 8m of resident permit holder bay

Removal of 2m of resident permit holder bay

Proposed continuous footway to improve walking and accessibility

Proposed continuous footway to improve walking and accessibility

Removal of 11.2m of resident permit holder bay

Upgrading existing zebra crossing to raised parallel crossing to help improve walking and accessibility

Existing cycle contraflow to be retained

6m of resident permit holder bay to be replaced with dockless hire bike parking bay

Proposed two cycle hangers

KEY

	Existing Road Marking		Existing Footway		Proposed Continuous Footway
	Proposed Road Marking		Proposed Footway		Proposed Rainwater Garden
	Removed Road Marking		Proposed Kerb		Proposed Sign on Existing Sign Post

Camden
 Design Team
 Transport Strategy Service
 London Borough of Camden
 5 Pancras Square
 Tel 020 7974 5551, Fax 020 7974 6952
 DX 2106 Euston, Minicom 020 7974 6866

Project
C51 - Kilburn to West Hampstead

Drawing Title
**Consultation Plan
 Sheet 1 of 7**

Scale	1 : 200 @ A3	Date	Nov 2024
Drawn By	SM	File Ref	-
Checked By	-	Dwg Name	-
Drawing Location	-		
Drawing Number	-		
Rev	By	Date	Amendments
A	SM	14/11/24	Perliminary

Rev. **A**



Key plan - Sheet 2

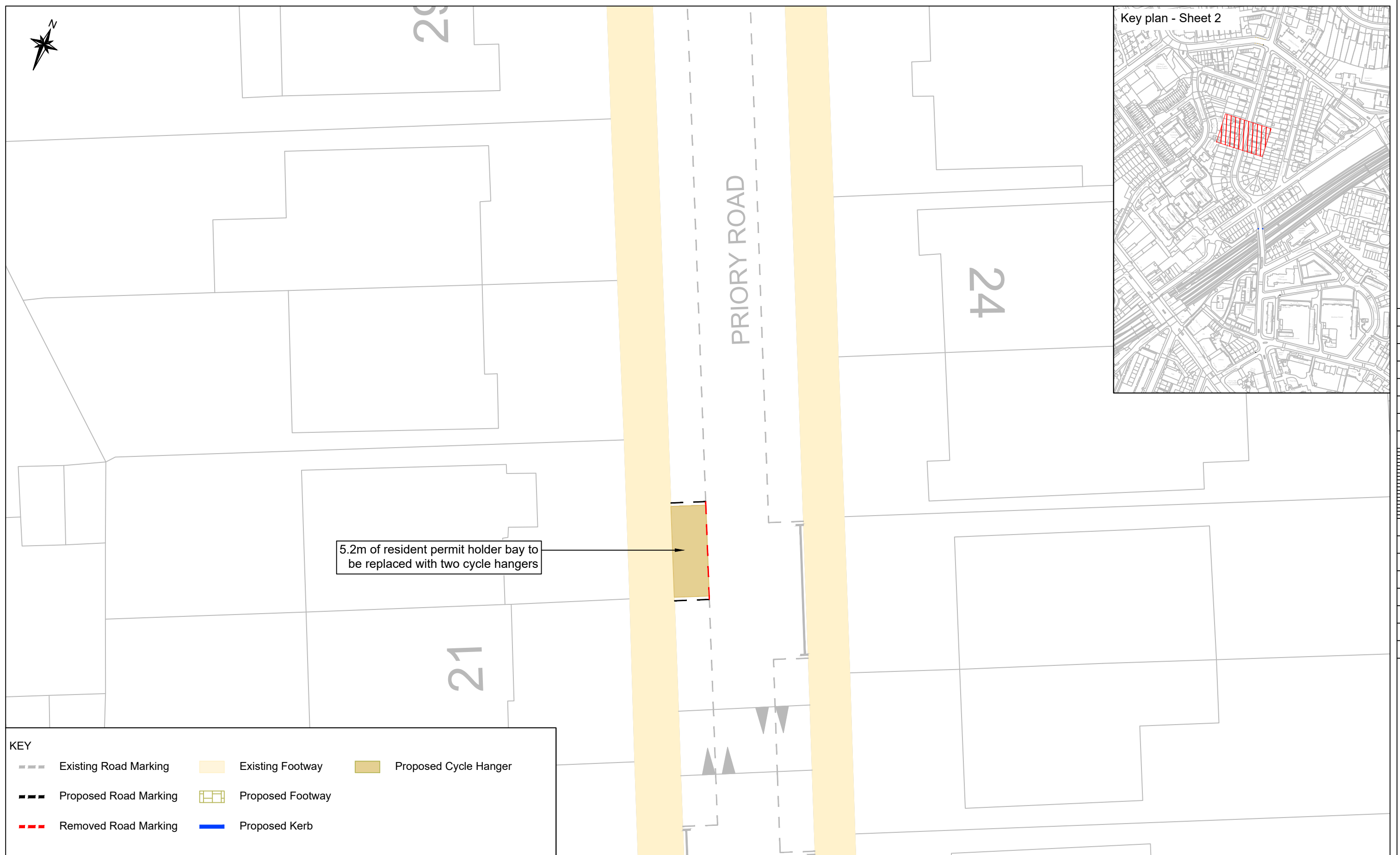
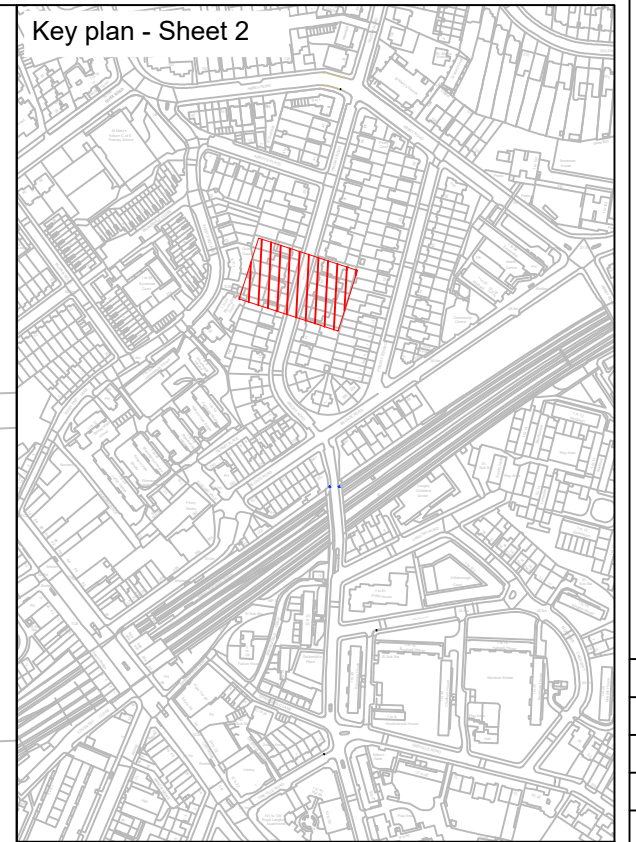

KEY		
	Existing Road Marking	
	Existing Footway	
	Proposed Cycle Hanger	
	Proposed Road Marking	
	Proposed Footway	
	Removed Road Marking	
	Proposed Kerb	

Camden
 Design Team
 Transport Strategy Service
 London Borough of Camden
 5 Pancras Square
 Tel 020 7974 5551, Fax 020 7974 6952
 DX 2106 Euston, Minicom 020 7974 6866

Project
C51 - Kilburn to West Hampstead

Drawing Title
**Consultation Plan
 Sheet 2 of 7**

Rev	By	Date	Amendments
A	SM	14/11/24	Perliminary

Scale 1 : 200 @ A3	Date Nov 2024
Drawn By SM	File Ref -
Checked By -	Dwg Name -
Drawing Location -	Drawing Number -
	Rev. A

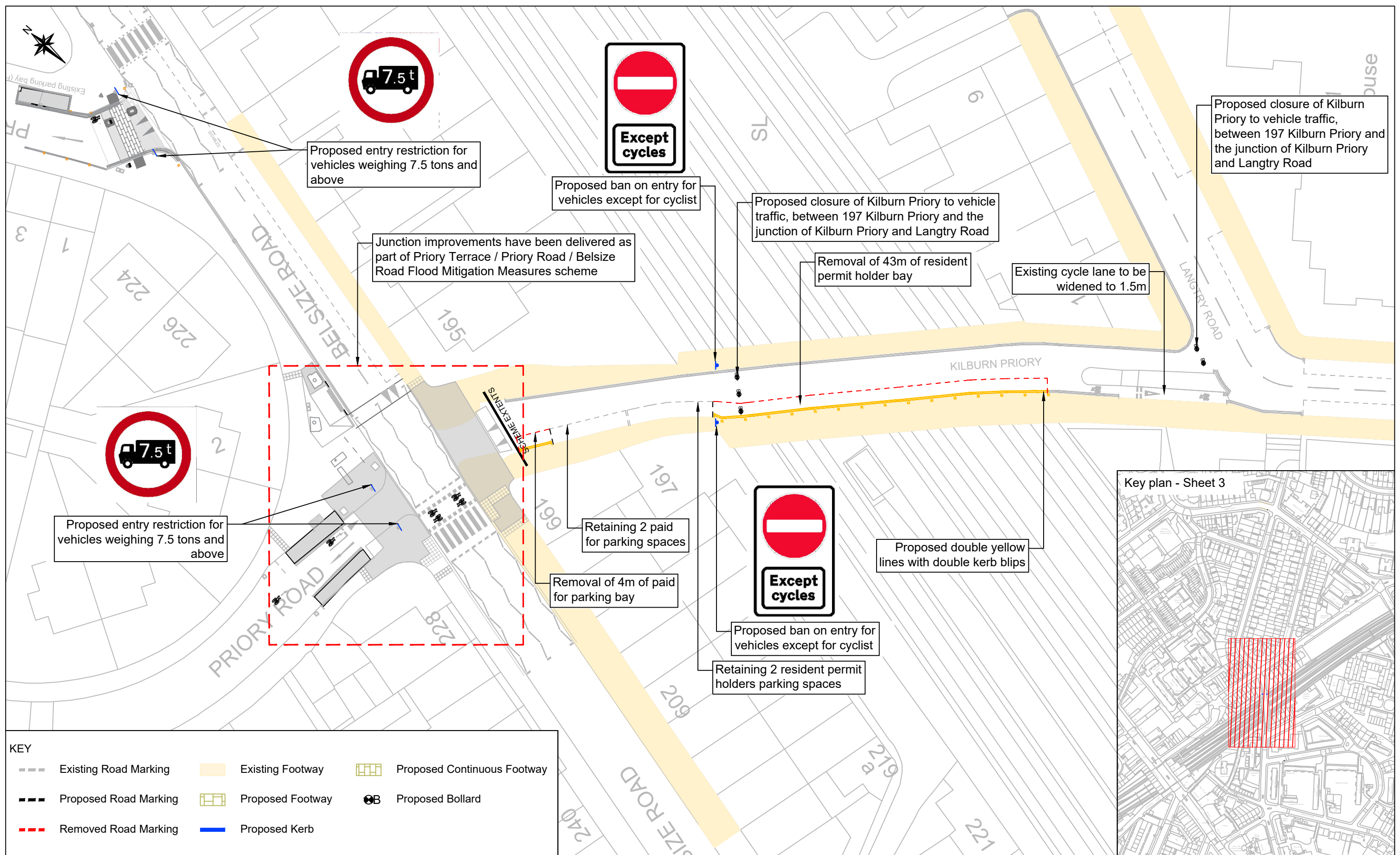

Proposed closure of Kilburn Priory to vehicle traffic, between 197 Kilburn Priory and the junction of Kilburn Priory and Langtry Road

Proposed closure of Kilburn Priory to vehicle traffic, between 197 Kilburn Priory and the junction of Kilburn Priory and Langtry Road

Removal of 43m of resident permit holder bay

Existing cycle lane to be widened to 1.5m

Proposed entry restriction for vehicles weighing 7.5 tons and above

Proposed ban on entry for vehicles except for cyclist

Junction improvements have been delivered as part of Priory Terrace / Priory Road / Belsize Road Flood Mitigation Measures scheme

Proposed entry restriction for vehicles weighing 7.5 tons and above

Retaining 2 paid for parking spaces

Removal of 4m of paid for parking bay

Proposed ban on entry for vehicles except for cyclist

Proposed double yellow lines with double kerb blips

Retaining 2 resident permit holders parking spaces

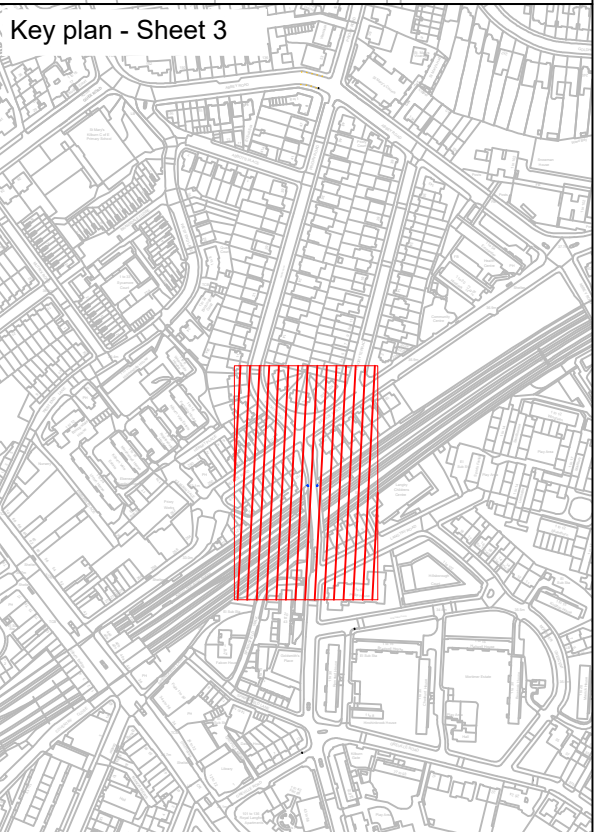

KEY					
	Existing Road Marking		Existing Footway		Proposed Continuous Footway
	Proposed Road Marking		Proposed Footway		Proposed Bollard
	Removed Road Marking		Proposed Kerb		

Camden
 Design Team
 Transport Strategy Service
 London Borough of Camden
 5 Pancras Square
 Tel 020 7974 5551, Fax 020 7974 6952
 DX 2106 Euston, Minicom 020 7974 6866

Project
C51 - Kilburn to West Hampstead

Drawing Title
**Consultation Plan
 Sheet 3 of 7**

Rev	By	Date	Amendments
A	SM	14/11/24	Perliminary

Scale NTS @ A3	Date Nov 2024
Drawn By SM	File Ref -
Checked By -	Dwg Name -
Drawing Location -	Drawing Number -
	Rev. A

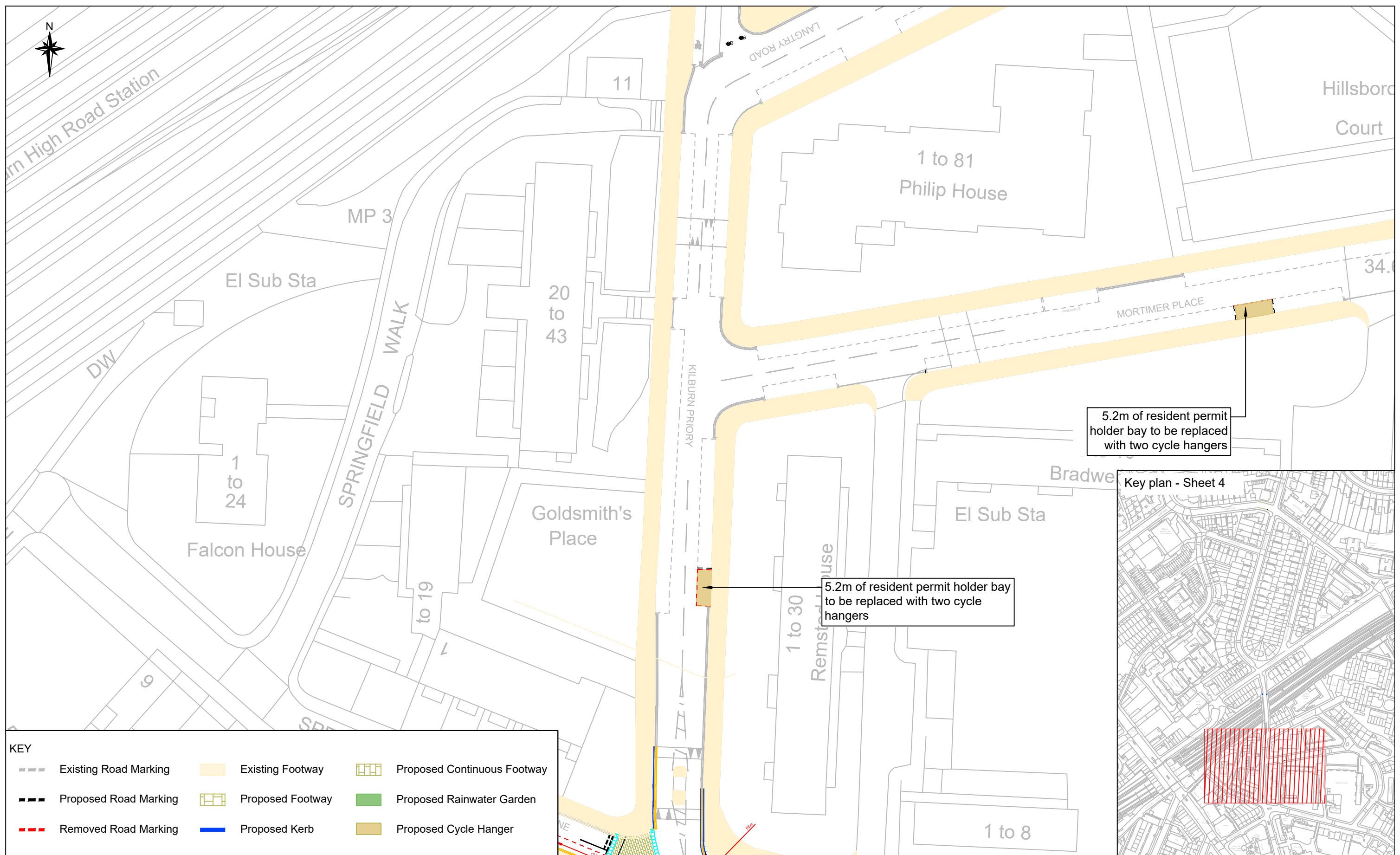

KEY

	Existing Road Marking		Existing Footway		Proposed Continuous Footway
	Proposed Road Marking		Proposed Footway		Proposed Rainwater Garden
	Removed Road Marking		Proposed Kerb		Proposed Cycle Hanger

5.2m of resident permit holder bay to be replaced with two cycle hangers

5.2m of resident permit holder bay to be replaced with two cycle hangers

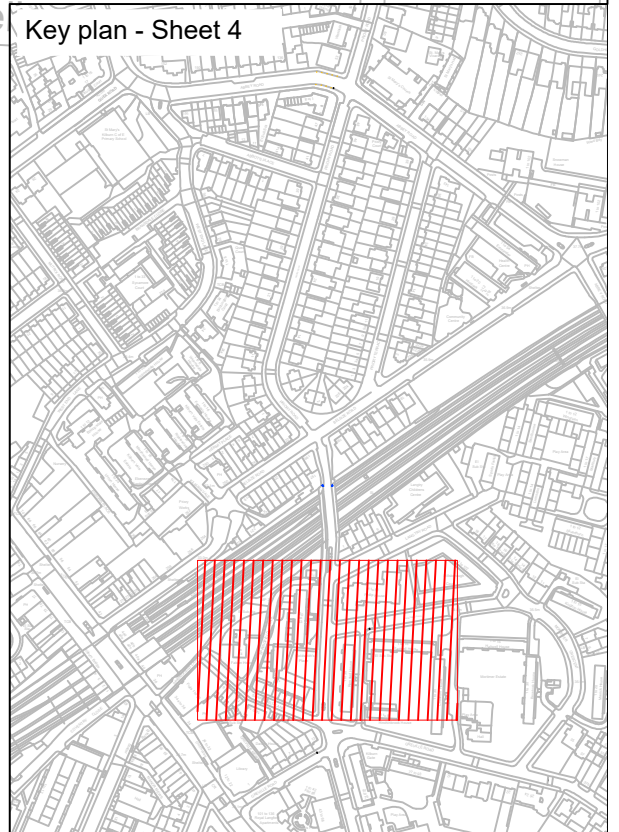

Camden
 Design Team
 Transport Strategy Service
 London Borough of Camden
 5 Pancras Square
 Tel 020 7974 5551, Fax 020 7974 6952
 DX 2106 Euston, Minicom 020 7974 6866

Project
C51 - Kilburn to West Hampstead

Drawing Title
**Consultation Plan
 Sheet 4 of 7**

Rev	By	Date	Amendments
A	SM	14/11/24	Perliminary

Scale 1 : 500 @ A3	Date Nov 2024
Drawn By SM	File Ref -
Checked By -	Dwg Name -
Drawing Location -	Drawing Number -
	Rev. A



1 to 8
Hinck

New rainwater garden to reduce flood risk and improve bio-diversity

Existing island to be removed

Proposed continuous crossing

SPRINGFIELD LANE

GREVILLE ROAD

Removal of 12m of resident permit holder bay

Proposed continuous footway to improve walking and accessibility

Proposed continuous crossing

Proposed footway extension to improve walking and accessibility

KILBURN PRIORY

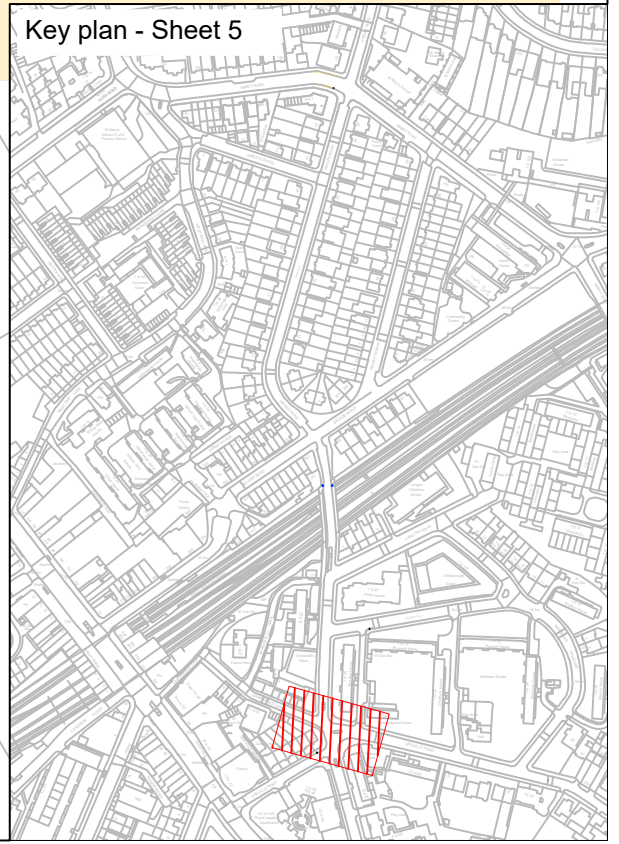

KEY

	Existing Road Marking		Existing Footway		Proposed Continuous Footway
	Proposed Road Marking		Proposed Footway		Proposed Rainwater Garden
	Removed Road Marking		Proposed Kerb		Proposed Dutch Kerb

Camden
 Design Team
 Transport Strategy Service
 London Borough of Camden
 5 Pancras Square
 Tel 020 7974 5551, Fax 020 7974 6952
 DX 2106 Euston, Minicom 020 7974 6866

Project
C51 - Kilburn to West Hampstead

Drawing Title
**Consultation Plan
 Sheet 5 of 7**

Rev	By	Date	Amendments
A	SM	14/11/24	Perliminary

Scale 1 : 200 @ A3	Date Nov 2024
Drawn By SM	File Ref -
Checked By -	Dwg Name -
Drawing Location -	Drawing Number -
Rev. A	

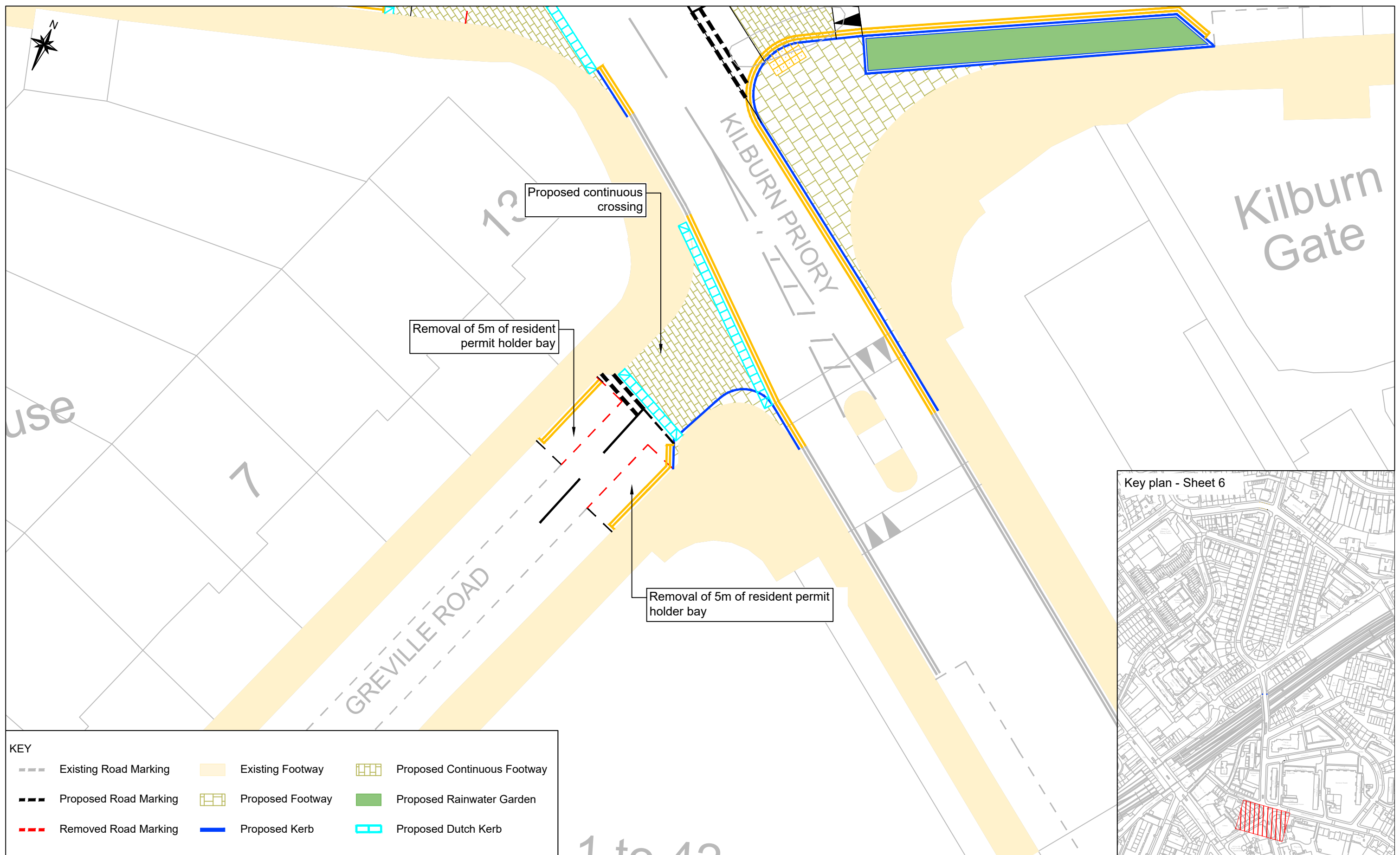

KEY

Existing Road Marking	Existing Footway	Proposed Continuous Footway
Proposed Road Marking	Proposed Footway	Proposed Rainwater Garden
Removed Road Marking	Proposed Kerb	Proposed Dutch Kerb

Camden
 Design Team
 Transport Strategy Service
 London Borough of Camden
 5 Pancras Square
 Tel 020 7974 5551, Fax 020 7974 6952
 DX 2106 Euston, Minicom 020 7974 6866

Project
C51 - Kilburn to West Hampstead

Drawing Title
**Consultation Plan
 Sheet 6 of 7**

Rev	By	Date	Amendments
A	SM	14/11/24	Perliminary

Scale 1 : 200 @ A3	Date Nov 2024
Drawn By SM	File Ref -
Checked By -	Dwg Name -
Drawing Location -	Drawing Number -
	Rev. A



Hall

Proposed change in priority at the junction between Greville Road and Mortimer Crescent

10m of resident permit holder bay to be replaced with dockless hire bike parking bay

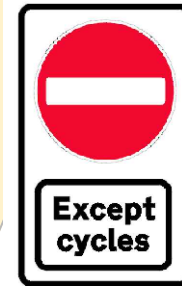

Proposed ban on entry for vehicles except for cyclist

Removal of 19m of resident permit holder bay

Key plan - Sheet 7

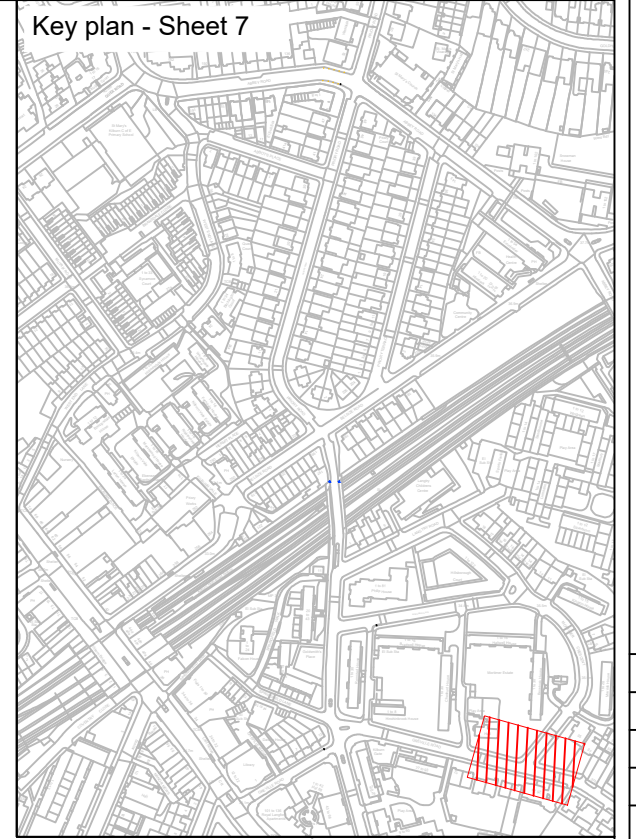

DISABLED

E-SCOOTERS & CYCLE HIRE

GREVILLE ROAD

MORTIMER CRESCENT

AHEAD ONLY

2m
3m

5.2m of resident permit holder bay to be replaced with two cycle hangers

Proposed cycle contraflow

Removal of 42m of resident permit holder bay

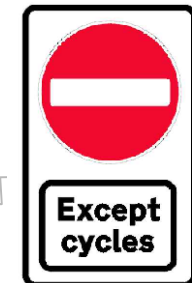

Proposed ban on entry for vehicles except for cyclist

KEY

- Existing Road Marking
- Existing Footway
- Proposed Cycle Hanger
- Proposed Road Marking
- Proposed Footway
- Proposed Planter
- Removed Road Marking
- Proposed Kerb
- Proposed Bollard

Camden
 Design Team
 Transport Strategy Service
 London Borough of Camden
 5 Pancras Square
 Tel 020 7974 5551, Fax 020 7974 6952
 DX 2106 Euston, Minicom 020 7974 6866

Project
C51 - Kilburn to West Hampstead

Drawing Title
**Consultation Plan
 Sheet 7 of 7**

Rev	By	Date	Amendments
A	SM	14/11/24	Perliminary

Scale 1 : 200 @ A3	Date Nov 2024
Drawn By SM	File Ref -
Checked By -	Dwg Name -
Drawing Location -	Drawing Number -
Rev. A	