

# DRAWING F- PROPOSED CHANGES ON MURRAY STREET

## Main scheme proposals:

- **Retention of traffic filter** trialled in temporary scheme (albeit modified, refer to drawing) with the associated benefits of reduced pollution, noise and vehicle danger
- **New raised table** to reduce vehicle speeds with **4 pedestrian crossings** (vs 2 currently)
- **New raised pedestrian crossing** across Murray St
- **New green areas** to encourage bio-diversity with SUDS features (Sustainable Urban Drainage Systems) to absorb surface water
- **Up to 11 new trees** (subject to trial holes) to provide additional shade and greenery
- Existing wooden 'streatory' to be replaced by **permanent footway** buildout for cafe tables and chairs
- **More footway space**
- **Enhanced environment for walking and cycling**

## KEY

- New granite kerb
- New granite kerb - flush with carriageway
- New white marking
- New yellow marking
- - - Parking removal
- ▨ New granite setts
- ▨ New footway buildout
- ▨ New planted area
- 🌳 New tree (indicative location, dependent on trial holes)

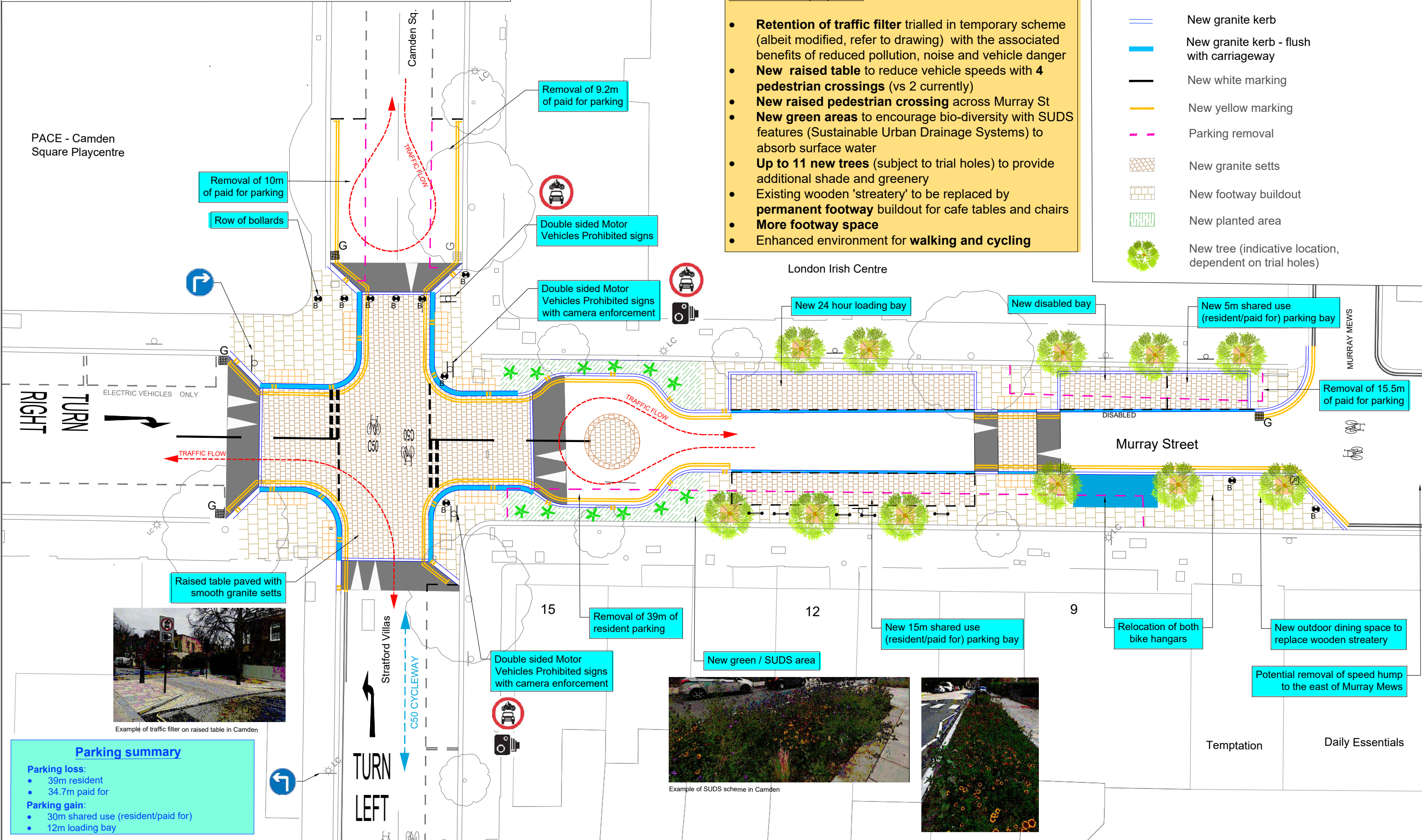

Raised table paved with smooth granite setts



Example of traffic filter on raised table in Camden

### Parking summary

- Parking loss:**
- 39m resident
  - 34.7m paid for
- Parking gain:**
- 30m shared use (resident/paid for)
  - 12m loading bay



Example of SUDS scheme in Camden

Rev	By	Date	Amendments

**DRAFT**