

FOR DETAIL REFER TO PAGE 3

FOR DETAIL REFER TO PAGE 7

FOR DETAIL REFER TO PAGE 6

FOR DETAIL REFER TO PAGE 4

FOR DETAIL REFER TO PAGE 5









FOR DETAIL REFER TO PAGE 2

NOTE: DOUBLE YELLOW LINES (NO WAITING AT ANY TIME) AND DOUBLE BLIPS (NO LOADING AT ANY TIME) ARE PROPOSED WITHIN THE SCHEME EXTENTS UNLESS OTHERWISE STATED

Camden
Design Team
Transport Strategy Service
London Borough of Camden
5 Pancras Square
Tel 020 7974 5551, Fax 020 7974 6952
DX 2106 Euston, Minicom 020 7974 6866

Project
**Safe and Healthy Streets
Clerkenwell Road**

Drawing Title
**Public Consultation
Scheme Overview
Sheet 1 of 7**

- Key**
-  Proposed Kerb
 -  Proposed Buildouts/Footway
 -  Proposed Footway with Emergency Access
 -  Proposed Stepped Track
 -  Proposed Continuous Footway
 -  Proposed Blue Cycle Surface
 -  Proposed Raised Table/Dutch Kerbs
 -  Proposed Greening

Rev	By	Date	Amendments

Scale NTS @ A1	Date JAN 24
Drawn By DS	File Ref
Checked By AC	Dwg Name
Drawing Location	
Drawing Number	Rev. 0

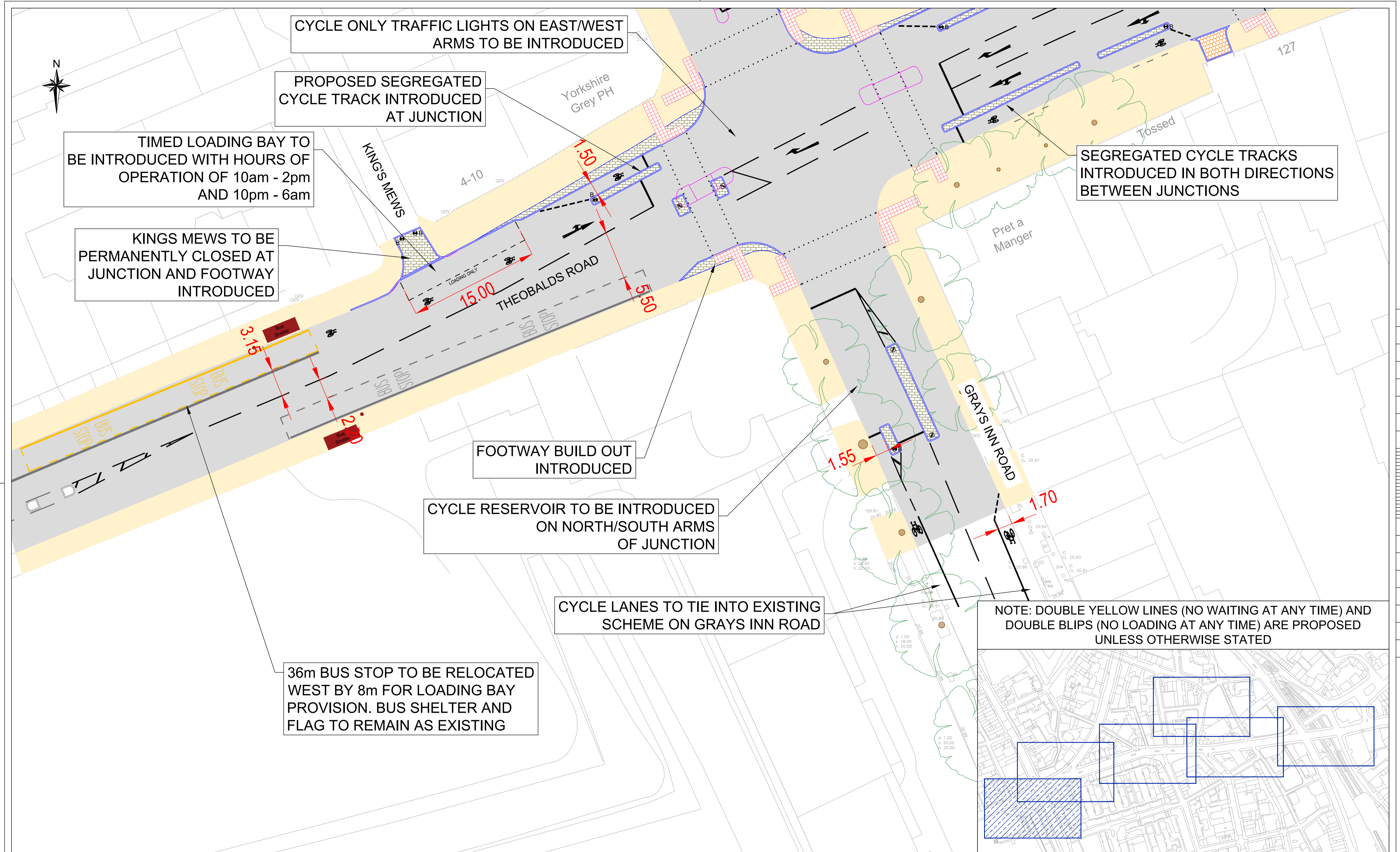

Rev	By	Date	Amendments

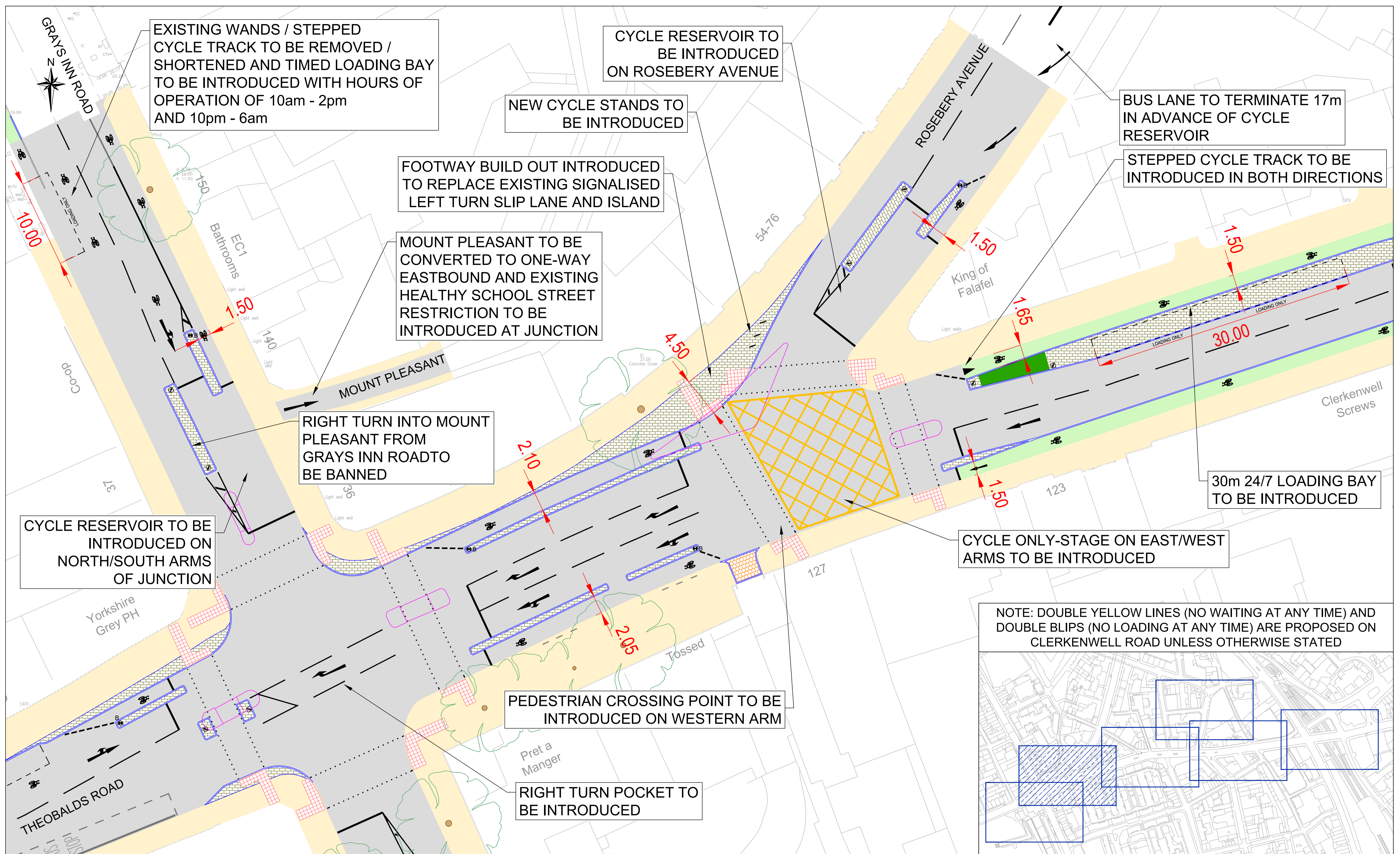

EXISTING WANDS / STEPPED CYCLE TRACK TO BE REMOVED / SHORTENED AND TIMED LOADING BAY TO BE INTRODUCED WITH HOURS OF OPERATION OF 10am - 2pm AND 10pm - 6am

CYCLE RESERVOIR TO BE INTRODUCED ON ROSEBERY AVENUE

NEW CYCLE STANDS TO BE INTRODUCED

BUS LANE TO TERMINATE 17m IN ADVANCE OF CYCLE RESERVOIR

STEPPED CYCLE TRACK TO BE INTRODUCED IN BOTH DIRECTIONS

FOOTWAY BUILD OUT INTRODUCED TO REPLACE EXISTING SIGNALISED LEFT TURN SLIP LANE AND ISLAND

MOUNT PLEASANT TO BE CONVERTED TO ONE-WAY EASTBOUND AND EXISTING HEALTHY SCHOOL STREET RESTRICTION TO BE INTRODUCED AT JUNCTION

RIGHT TURN INTO MOUNT PLEASANT FROM GRAYS INN ROAD TO BE BANNED

30m 24/7 LOADING BAY TO BE INTRODUCED

CYCLE RESERVOIR TO BE INTRODUCED ON NORTH/SOUTH ARMS OF JUNCTION

CYCLE ONLY-STAGE ON EAST/WEST ARMS TO BE INTRODUCED

NOTE: DOUBLE YELLOW LINES (NO WAITING AT ANY TIME) AND DOUBLE BLIPS (NO LOADING AT ANY TIME) ARE PROPOSED ON CLERKENWELL ROAD UNLESS OTHERWISE STATED

PEDESTRIAN CROSSING POINT TO BE INTRODUCED ON WESTERN ARM

RIGHT TURN POCKET TO BE INTRODUCED

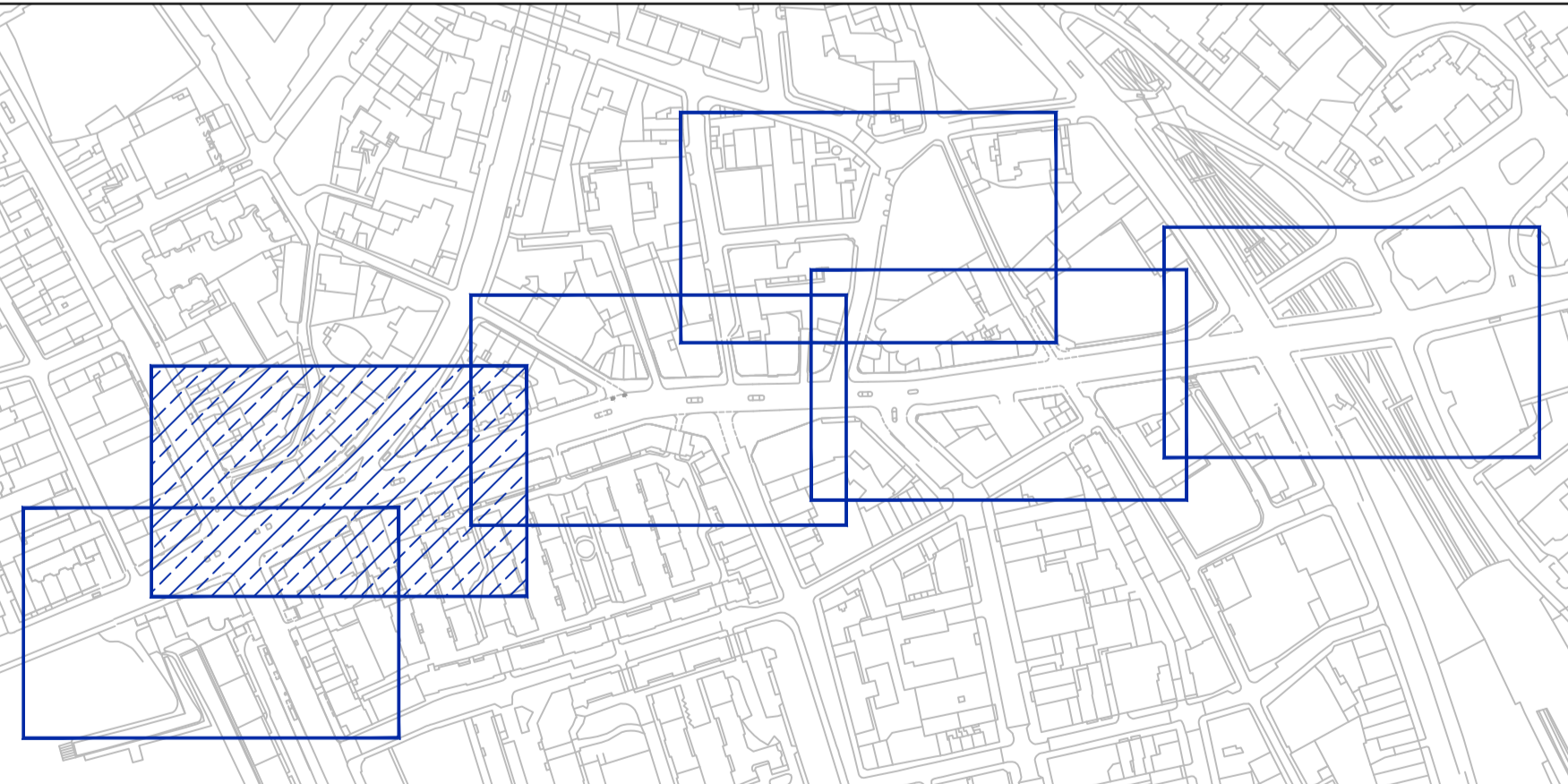

Rev	By	Date	Amendments

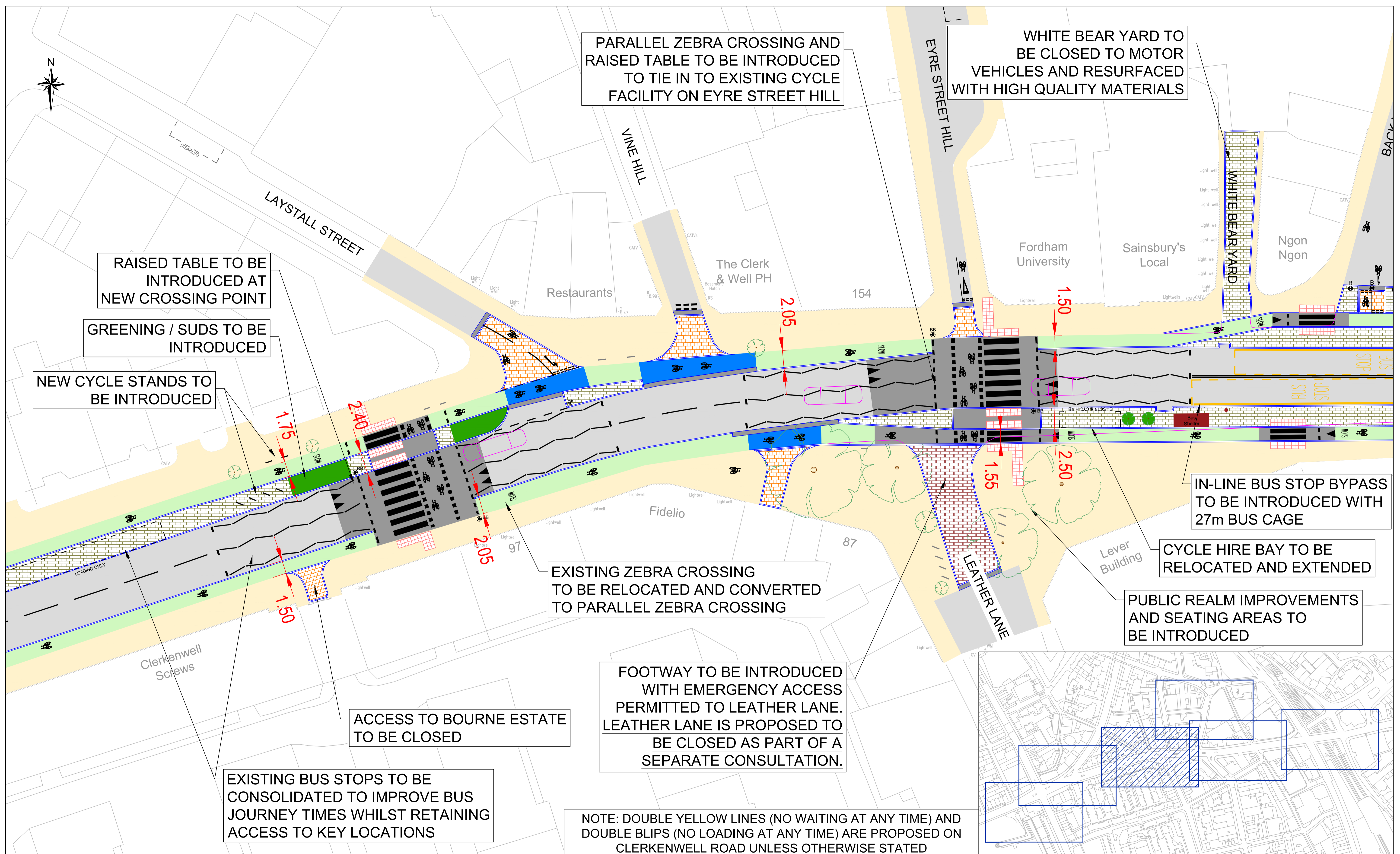

PARALLEL ZEBRA CROSSING AND RAISED TABLE TO BE INTRODUCED TO TIE IN TO EXISTING CYCLE FACILITY ON EYRE STREET HILL

WHITE BEAR YARD TO BE CLOSED TO MOTOR VEHICLES AND RESURFACED WITH HIGH QUALITY MATERIALS

RAISED TABLE TO BE INTRODUCED AT NEW CROSSING POINT

GREENING / SUDS TO BE INTRODUCED

NEW CYCLE STANDS TO BE INTRODUCED

IN-LINE BUS STOP BYPASS TO BE INTRODUCED WITH 27m BUS CAGE

CYCLE HIRE BAY TO BE RELOCATED AND EXTENDED

PUBLIC REALM IMPROVEMENTS AND SEATING AREAS TO BE INTRODUCED

EXISTING ZEBRA CROSSING TO BE RELOCATED AND CONVERTED TO PARALLEL ZEBRA CROSSING

FOOTWAY TO BE INTRODUCED WITH EMERGENCY ACCESS PERMITTED TO LEATHER LANE. LEATHER LANE IS PROPOSED TO BE CLOSED AS PART OF A SEPARATE CONSULTATION.

ACCESS TO BOURNE ESTATE TO BE CLOSED

EXISTING BUS STOPS TO BE CONSOLIDATED TO IMPROVE BUS JOURNEY TIMES WHILST RETAINING ACCESS TO KEY LOCATIONS

NOTE: DOUBLE YELLOW LINES (NO WAITING AT ANY TIME) AND DOUBLE BLIPS (NO LOADING AT ANY TIME) ARE PROPOSED ON CLERKENWELL ROAD UNLESS OTHERWISE STATED

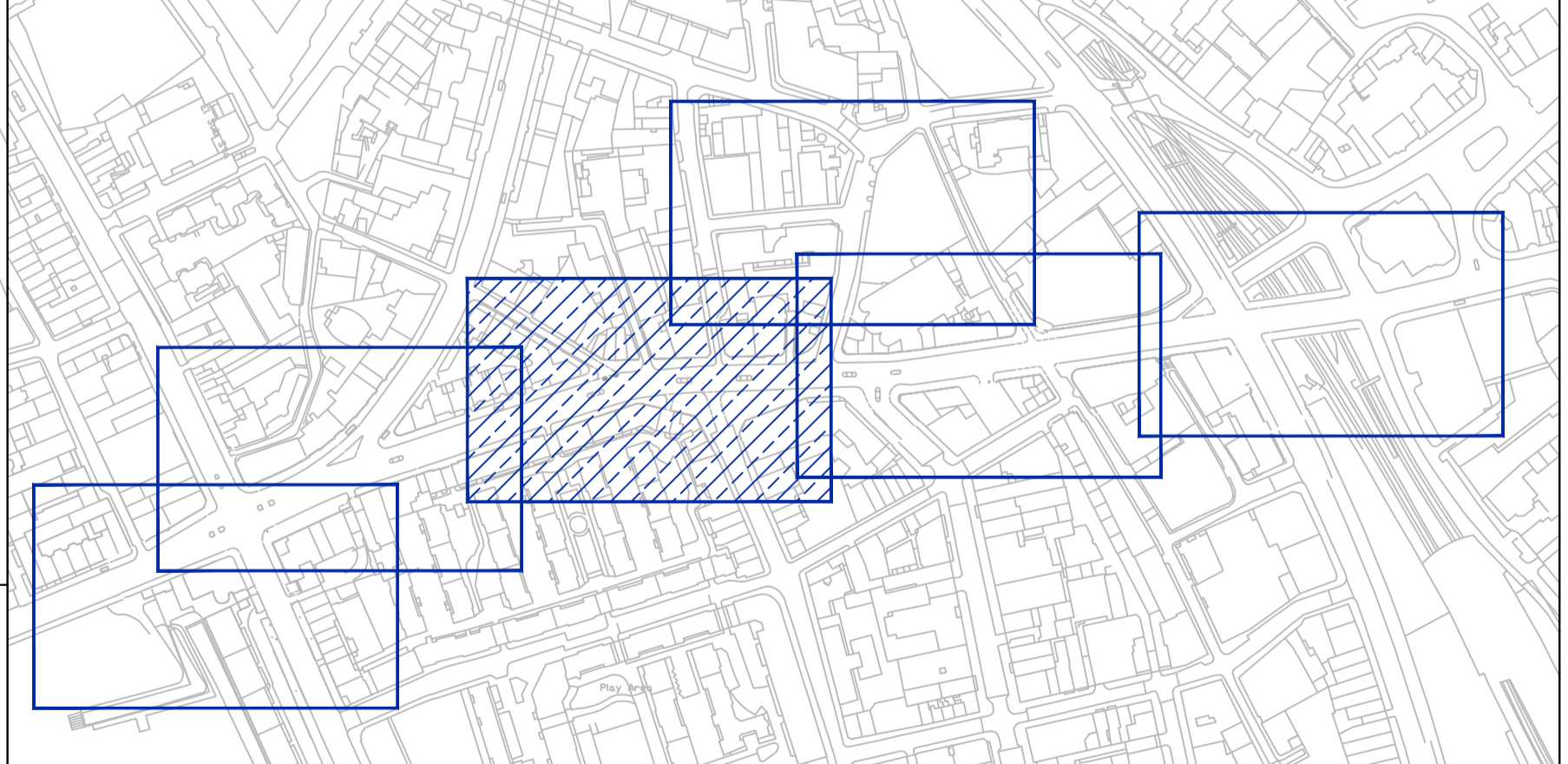

Rev	By	Date	Amendments

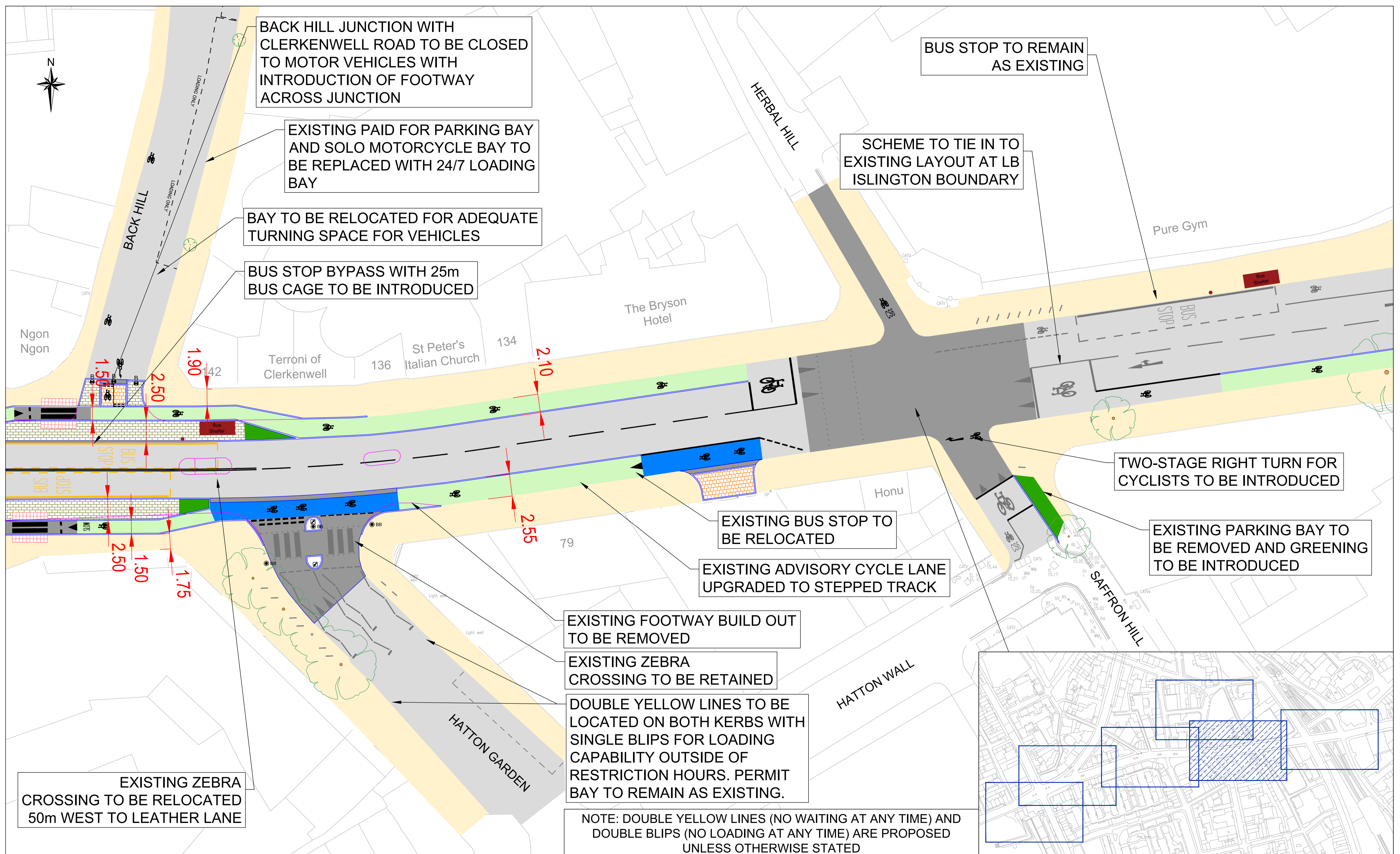

Rev	By	Date	Amendments

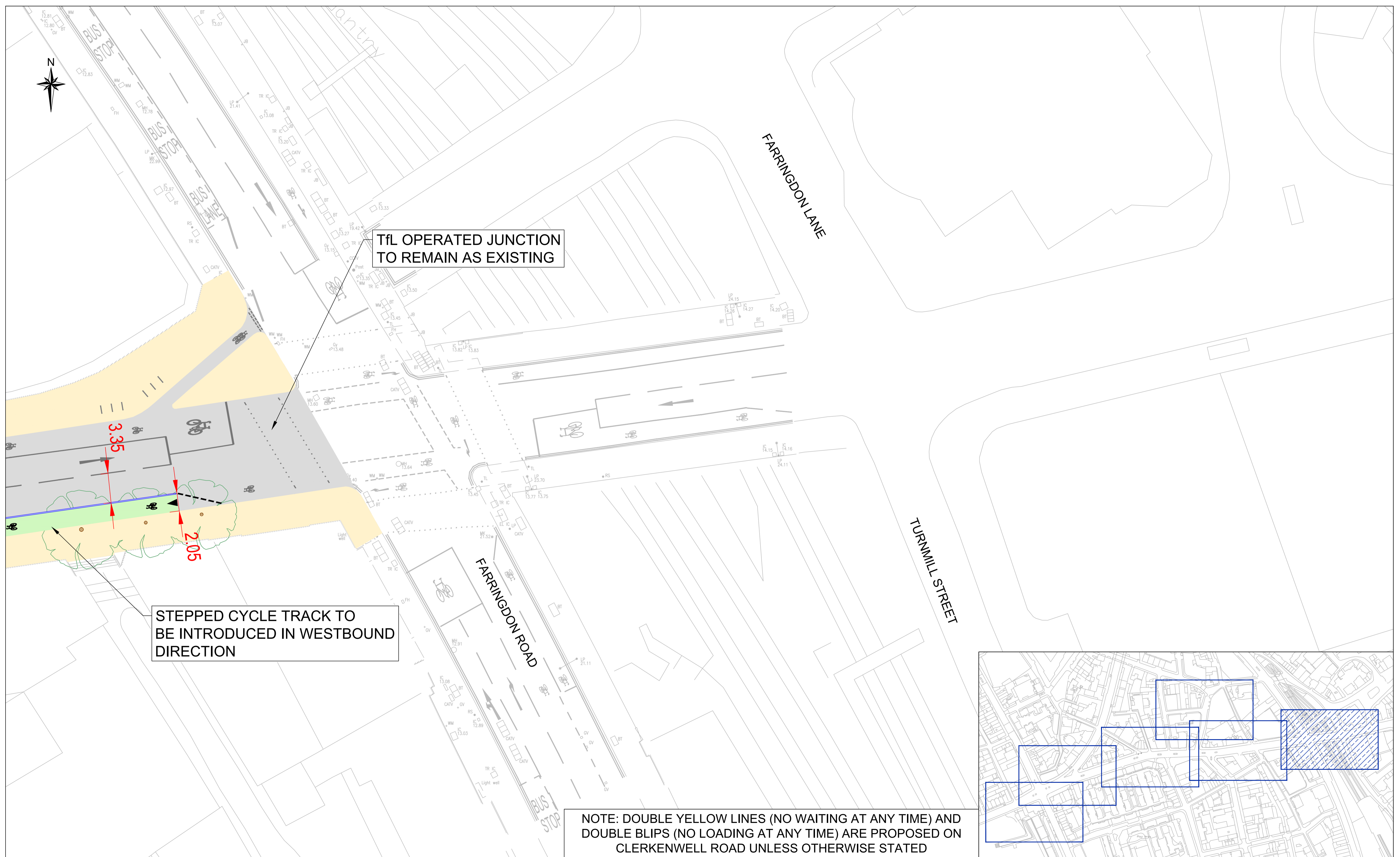

Key

	Proposed Kerb
	Proposed Buildouts/Footway
	Proposed Footway with Emergency Access
	Proposed Stepped Track
	Proposed Continuous Footway
	Proposed Blue Cycle Surface
	Proposed Raised Table/Dutch Kerbs
	Proposed Greening

Rev	By	Date	Amendments

Scale 1 : 200 @ A1	Date JAN 24
Drawn By DS	File Ref
Checked By AC	Dwg Name
Drawing Location	
Drawing Number	Rev. 0

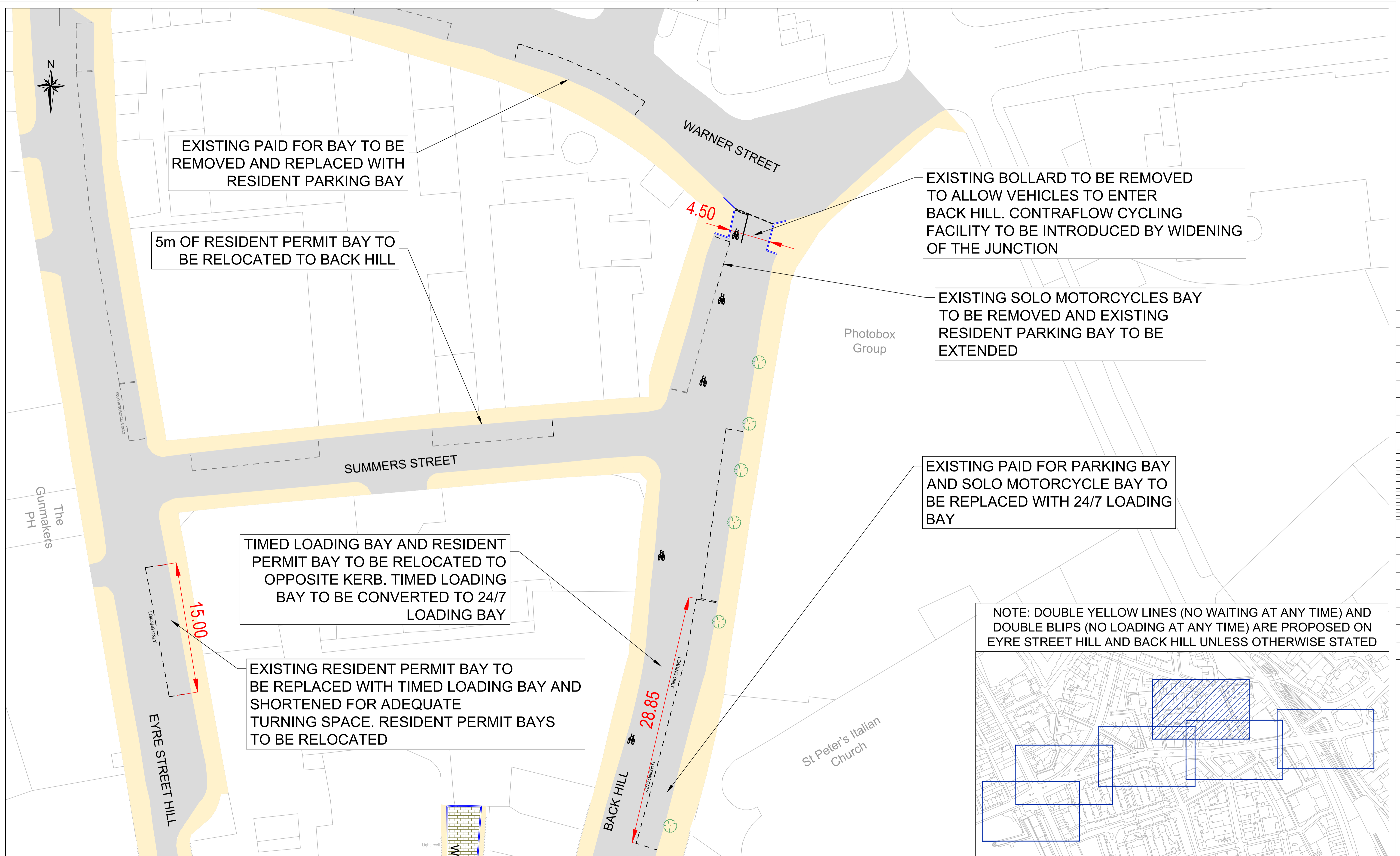

Rev	By	Date	Amendments