

**Date:** 21 Jan 2020  
**Our reference:** TS// Gilden Crescent  
**Contact** 020 7974 5071/2520  
**Email:** [TransportConsultations@camden.gov.uk](mailto:TransportConsultations@camden.gov.uk)



Transport Strategy Service  
Supporting People  
London Borough of Camden  
5 Pancras Square  
London  
N1C 4AG

Phone: 020 7974 5071/2520  
[camden.gov.uk](http://camden.gov.uk)

Dear Sir or Madam,

## **HAVE YOUR SAY**

### **New lockable cycle parking proposed for Gilden Crescent, NW5**

I am writing to let you know that Camden Council is proposing to install two 'cycle hangars' on Gilden Crescent, NW5.

Residents in Camden have told us that they would like to have more lockable cycle parking close to where they live. We know that a lack of somewhere to keep a cycle safely can put people off taking up cycling. As a result, Camden Council is rolling out a programme of installing cycle hangars across the borough. This is also in line with the [Camden Transport Strategy](#), which aims to encourage more residents in Camden to travel by cycle.

### **What we are proposing to install**

We are proposing to install two cycle hangars on Gilden Crescent, on 5.3m of Resident Permit Holder's bay, close to the junction with Malden Road, replacing it with Resident Cycle Parking. Single yellow line adjacent to the proposed hangars will be converted to double yellow line

A plan of the proposal is shown on the drawing overleaf

- Two 'Cyclehoop' secure cycle parking units (providing storage for up to 12 cycles).
- Each unit is 1.36m high with a curved profile roof (see images below).
- The annual membership fee for a single space within a unit is £30.00. (Excluding VAT)

### **Are you eligible?**

The criteria for being able to hire a space in a cycle hangar prioritise residents who:

- Live on the street (or an adjacent one) where the hangar is proposed; and,
- Do not have suitable outside space for keeping a cycle.

The council installs the unit while the manufacturer (Cyclehoop) will maintain the hangar. The cost of maintenance is covered by the annual membership fee.

You can find more information, including Frequently Asked Questions, on the consultation page for this proposal on the We Are Camden Website, [consultations.wearecamden.org](http://consultations.wearecamden.org). If approved, we will install the bike hangar in the 2019/20 financial year.

## Plan of proposal

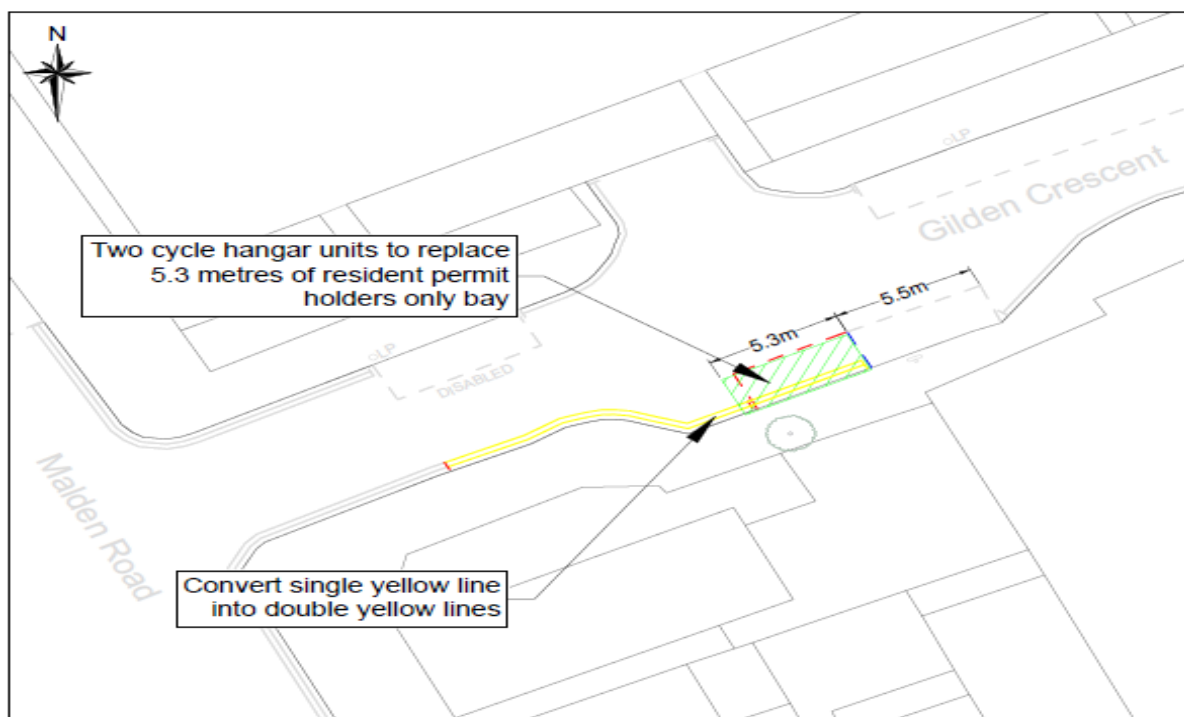

## Images of Bikehangars



The above images show both external and internal views of the units. They have reflective strips on the side for safety & visibility at night. If approved, the units will be installed in **green** colour only.

## **This is your opportunity to comment**

The Council will be pleased to hear your views on the proposals as well as any alternative suggestions or objections you may have to any aspect of what we are proposing.

### **HOW TO RESPOND?**

**Please submit your response to this consultation no later than 11 Feb 2020 via one of the following three options below:**

**Option 1 Online** – submit your comments on an online form, which can be found using this link: <https://consultations.wearecamden.org/supporting-communities/cycle-parking-gilden>

**Option 2 Email** – submit your comments via email to:  
[TransportConsultations@camden.gov.uk](mailto:TransportConsultations@camden.gov.uk)

**Option 3 Post** – submit your response using the following **free post address** (no stamp required) to **Freepost LBC Mailroom, Transport Strategy**

**Please Note:** if you are responding on behalf of an organisation, only **ONE** reply will be accepted. You **must** give your full postal address when responding to the consultation if you want us to consider your views.

An Equality & Diversity form has been included that is voluntary for you to complete and send to us with your response via email or using free post address as outlined above. Any information you provide on this form will help us in making an informed decision.

### **Who is being consulted?**

All properties located close to the proposals, local groups, statutory groups and ward councillors.

While it will not be possible to reply to you individually, all comments will be taken into account. At the end of this consultation period, officers will consider all responses received and write a report with recommendations. This report will be presented to the Director of Regeneration and Planning (Supporting Communities Directorate) who will make a decision whether or not to proceed with implementing the proposals.

Under the Local Government Access to Information Act 1985, your consultation response will be available for inspection if required; however, your personal details will remain confidential. Please only write to us with matters associated with this consultation. If you do have any further questions or require clarification about the proposed scheme, please contact Richard Riddle/Paul Davis on 020 7974 5071 or 020 7974 2520.

Yours Sincerely

Richard Riddle, Cycling Officer, London Borough of Camden