

KEY

-  PROPOSED FOOTWAY/ISLAND
-  EXISTING FOOTWAY
-  PROPOSED CYCLE LANE BLUE SURFACING
-  PROPOSED WHITE LINE MARKING
-  PROPOSED TACTILE PAVING
-  PROPOSED GREENING / RAINGARDEN
(subject to further investigation to establish viability)
-  PROPOSED TREE
-  EXISTING TREE

A	A.B.	00.00.06	Preliminary
Rev	By	Date	Amendments



Design Team
Transport Strategy Service
London Borough of Camden
5 Pancras Square
Tel 020 7974 5551, Fax 020 7974 6952
DX 2106 Euston, Minicom 020 7974 6866

Project

**GOODS WAY
SIGNALISED CROSSINGS
& IMPROVED CYCLE FACILITIES**

Drawing Title

CONSULTATION DRAWING
SHEET 2 OF 3

Scale 1:500 @ A3	Date FEB 2024
Drawn By JA	File Ref
Checked By	Dwg Name
Drawing Location	
Drawing Number TS/CYC/GOODSWY/JA-CONS2	
Rev. A	

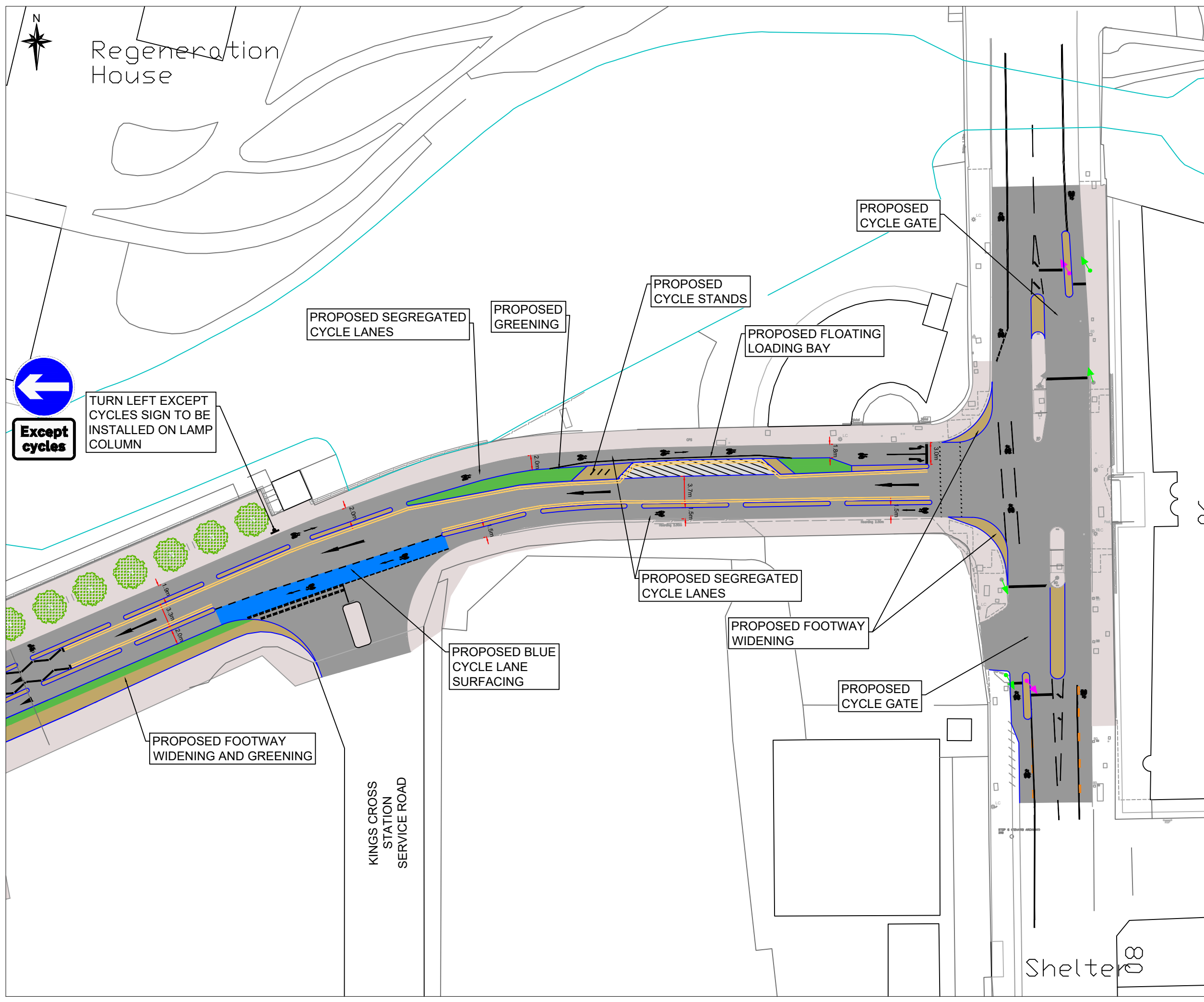

- KEY**
- PROPOSED FOOTWAY/ISLAND
 - EXISTING FOOTWAY
 - PROPOSED CYCLE LANE BLUE SURFACING
 - PROPOSED WHITE LINE MARKING
 - PROPOSED TACTILE PAVING
 - PROPOSED GREENING / RAINGARDEN (subject to further investigation to establish viability)
 - PROPOSED TREE
 - EXISTING TREE

A	A.B.	00.00.06	Preliminary
Rev	By	Date	Amendments

**Camden**

Design Team
Transport Strategy Service
London Borough of Camden
5 Pancras Square
Tel 020 7974 5551, Fax 020 7974 6952
DX 2106 Euston, Minicom 020 7974 6866

Project
**GOODS WAY
JUNCTION MODIFICATION
& IMPROVED CYCLE FACILITIES**

Drawing Title
**CONSULTATION DRAWING
SHEET 3 OF 3**

Scale 1:500 @ A3	Date FEB 2024
Drawn By JA	File Ref
Checked By	Dwg Name

Drawing Location	
Drawing Number TS/CYC/GOODSWY/JA-CONS3	Rev. A