

PROPOSED HEALTHY SCHOOL STREET
FOLDING SIGNS TO BE PLACED ON
EXISTING SIGNAGE POLES

CHRIST CHURCH PRIMARY SCHOOL

POTENTIAL FOR TRAFFIC
ENFORCEMENT CAMERA MONITORING
WITH NEW 6m POLE. SUBJECT TO
FEASIBILITY STUDY

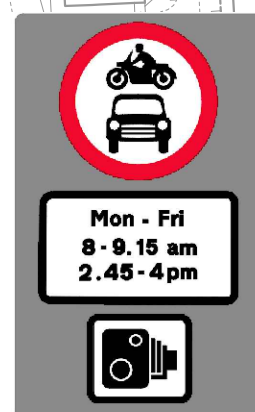

PROPOSED HEALTHY SCHOOL STREET
FOLDING SIGNS TO BE PLACED ON
EXISTING SIGNAGE POLES

POTENTIAL TO REMOVE
GUARD RAILING

EXISTING PUPIL ENTRANCE

HEALTHY SCHOOL STREET
RESTRICTED AREA

NO THROUGH ROAD SIGNS
TO BE INSTALLED ON NEW
3m SIGNAGE POLES

PLANTERS AND DROPPABLE BOLLARD TO BE INTRODUCED IN CARRIAGEWAY TO PREVENT THROUGH ACCESS BETWEEN REDHILL ST AND CUMBERLAND MARKET. NO MOTOR VEHICLE SIGNS TO BE INSTALLED IN PLANTERS

NO THROUGH ROAD SIGNS
TO BE INSTALLED ON NEW
3m SIGNAGE POLES



Project	London Borough of Camden Euston Area Scheme
---------	--

Drawing Title	<p>Christ Church Primary School</p> <p>Healthy School Streets</p> <p>Page 1 of 3</p>
---------------	--

Key



Existing lighting column
Existing Pupil Entrance
Existing Signage Pole
Proposed Signage Pole
Proposed Signage
Proposed Timed Road Closure Area

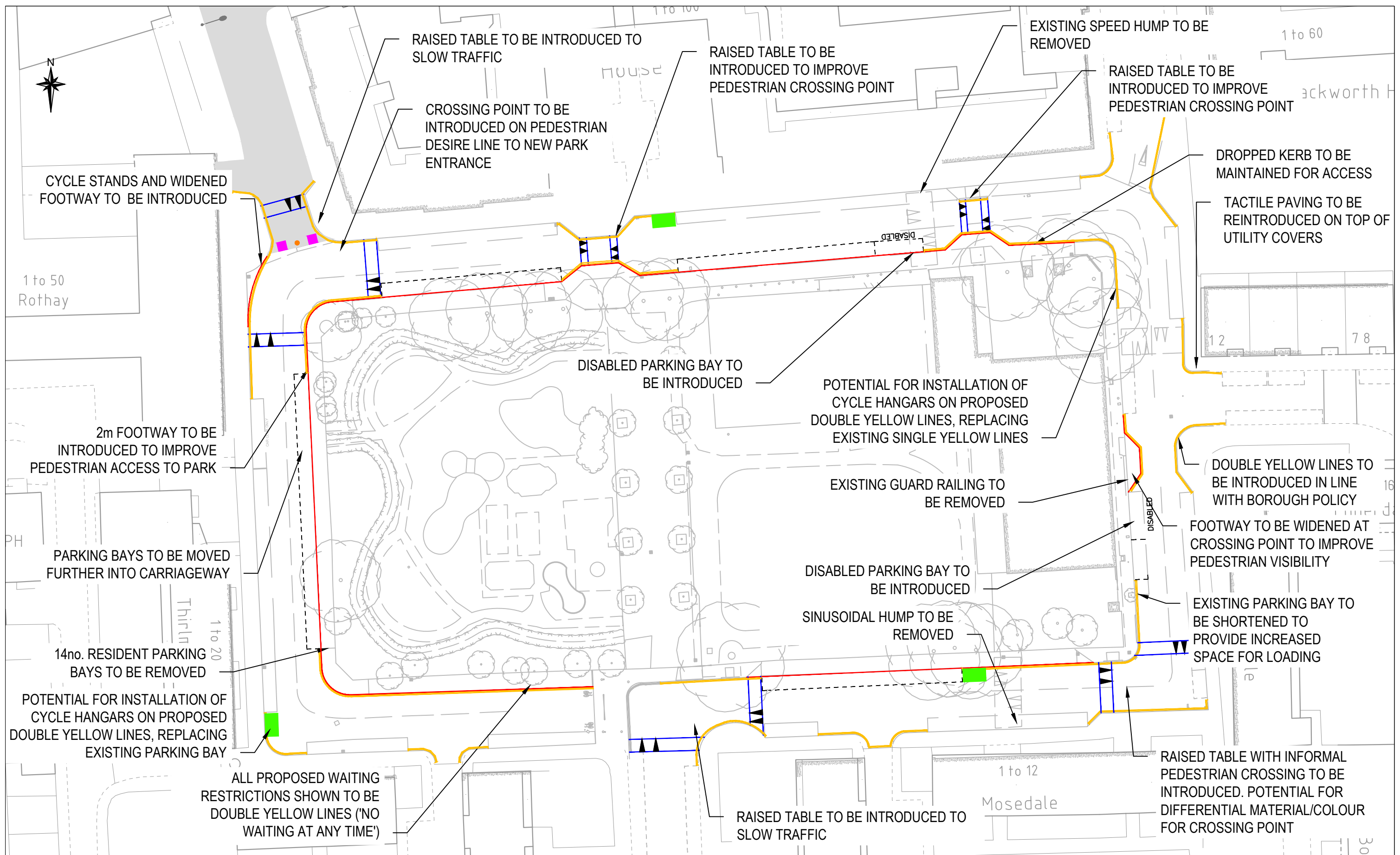

				Scale NTS @ A3	Date JAN 22
				Drawn By DS	File Ref
				Checked By	Dwg Name
				Drawing Location	
				Drawing Number	
Rev	Bv	Date	Amendments		Rev. A





Camden
Design Team
Transport Strategy Service
London Borough of Camden
5 Pancras Square
Tel 020 7974 5551, Fax 020 7974 6952
DX 2106 Euston, Minicom 020 7974 6866

Project	London Borough of Camden Euston Area Scheme
Drawing Title	Cumberland Market Footway Widening Page 3 of 3

Key	
	Proposed Signage Pole
	Proposed Signage
	Proposed Timed Road Closure Area
	Proposed Kerbline
	Proposed Planters
	Proposed Bollards
	Proposed Traffic Calming
	Proposed Waiting Restrictions
	Proposed Cycle Hangar

Rev	By	Date	Amendments

Scale NTS @ A3	Date JAN 22
Drawn By DS	File Ref
Checked By	Dwg Name
Drawing Location	
Drawing Number	Rev. A