







# CAMDEN LOCK VILLAGE - HAWLEY WHARF DEVELOPMENT PROPOSED CHANGES TO IMPROVE SAFETY AND FACILITATE SERVING OF DEVELOPMENT



## KEY

-  Existing footway
-  Proposed widened footway
-  Proposed crossovers
-  Existing road markings
-  Proposed road markings
-  Proposed cycle stands

10 metres of carriageway marked with double yellow lines and single kerb blips, along which loading will be banned during the following days and times:  
Monday-Friday  
7am - 10am & 4pm - 7pm

Widen footway to improve safety for pedestrians crossing at zebra crossing outside school

Remove permanently approximately 9 resident permit holders' parking spaces (which are now suspended for development construction works) to improve sightlines at zebra crossing and to allow for new crossovers

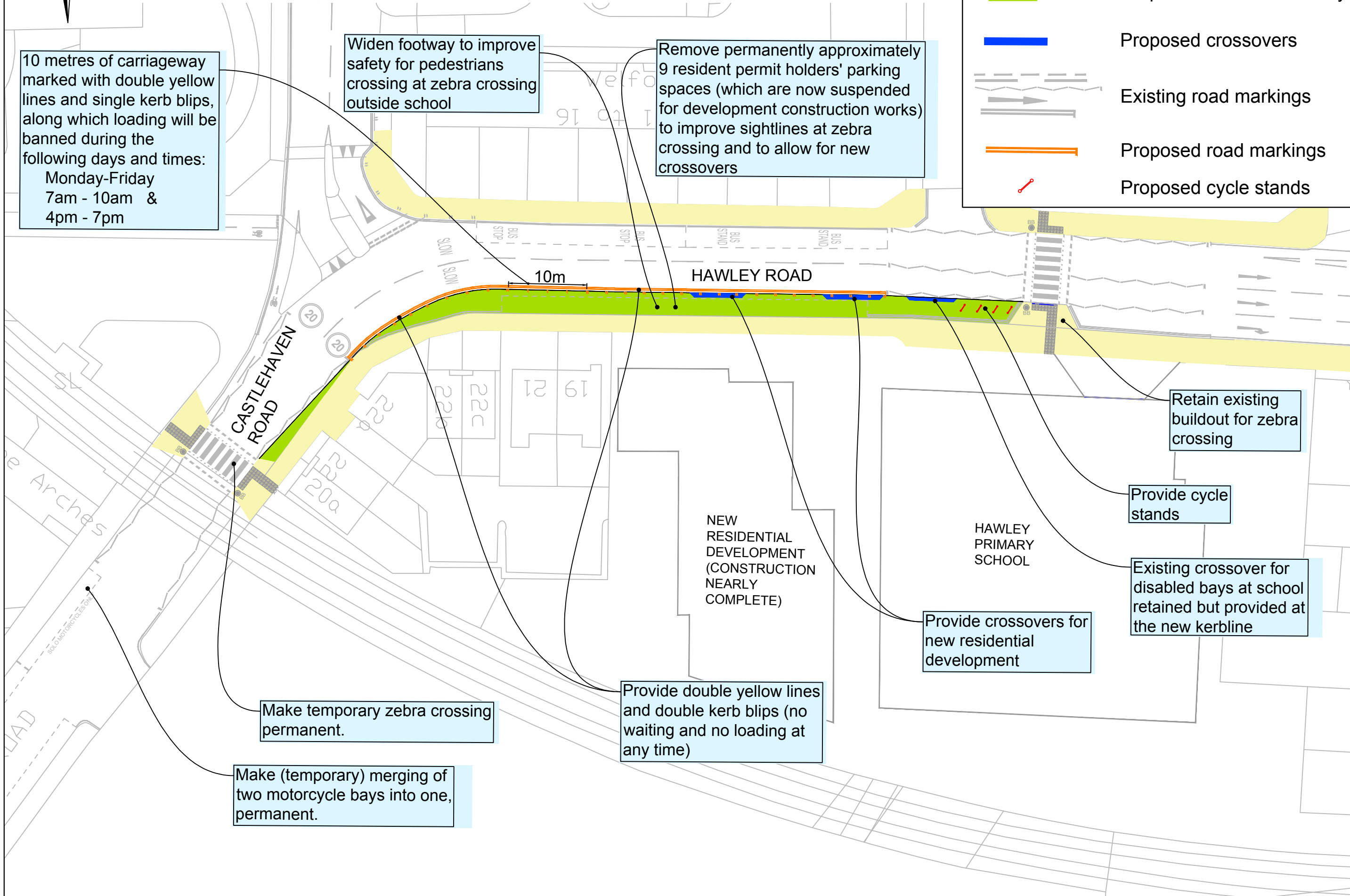

Make temporary zebra crossing permanent.

Make (temporary) merging of two motorcycle bays into one, permanent.

Provide double yellow lines and double kerb blips (no waiting and no loading at any time)

Provide crossovers for new residential development

Retain existing buildout for zebra crossing

Provide cycle stands

Existing crossover for disabled bays at school retained but provided at the new kerbline

NEW RESIDENTIAL DEVELOPMENT (CONSTRUCTION NEARLY COMPLETE)

HAWLEY PRIMARY SCHOOL

10m

HAWLEY ROAD

CASTLEHAVEN ROAD

Arches

20

20

22a

22b

22c

21

19

61

20a

20b

20c

20d

20e

20f

20g

20h

20i

20j

20k

20l

20m

20n

20o

20p

20q

20r

20s

20t

ROAD

ROAD

ROAD