

Rev	By	Date	Amendments
A	SM	10/10/24	Preliminary

PROPOSED LAYOUT

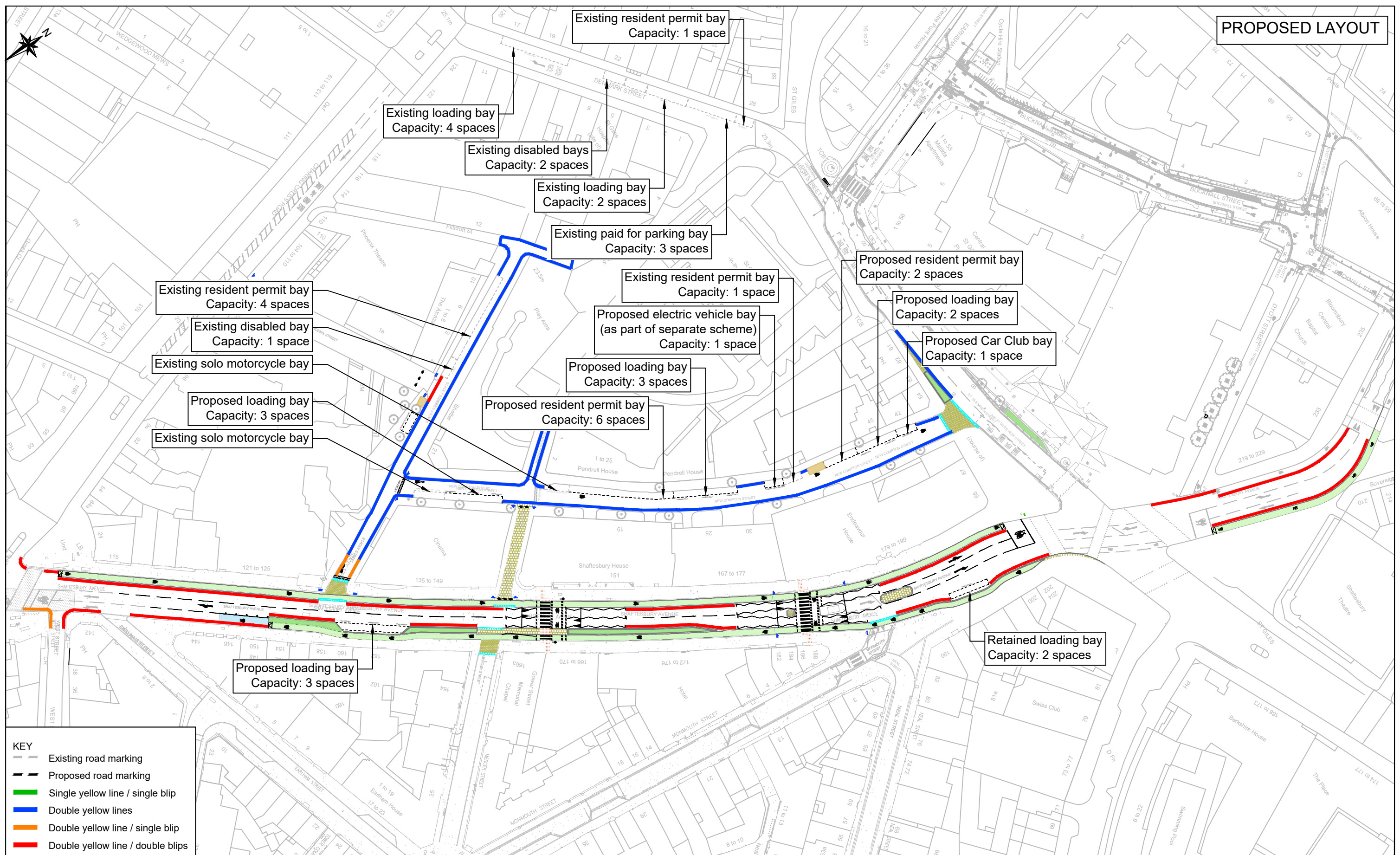

KEY

- Existing road marking
- Proposed road marking
- Single yellow line / single blip
- Double yellow lines
- Double yellow line / single blip
- Double yellow line / double blips

Camden
 Design Team
 Transport Strategy Service
 London Borough of Camden
 5 Pancras Square
 Tel 020 7974 5551, Fax 020 7974 6952
 DX 2106 Euston, Minicom 020 7974 6866

Project
**Shaftesbury Avenue Area
 Safe and Healthy Streets**

Drawing Title
**Public Consultation
 Existing and Proposed Parking & Loading Plan
 Sheet 2 of 2**

Scale	1:1000 @ A3
Drawn By	SM
Checked By	HD
Drawing Location	-
Drawing Number	-
Date	10/10/24
Rev	By
	SM
	10/10/24
	Preliminary
	Amendments

Date	Oct 2024
File Ref	-
Dwg Name	-
Rev	A